



US009022673B2

(12) **United States Patent**
Orton et al.

(10) **Patent No.:** **US 9,022,673 B2**
(45) **Date of Patent:** **May 5, 2015**

(54) **DEVICE SUPPORT AND TRIGGER APPARATUS**

(56) **References Cited**

U.S. PATENT DOCUMENTS

- (71) Applicant: **KNEKT Industries Ltd.**, Kailua, HI (US)
- (72) Inventors: **Benjamin Bodi Orton**, Clearlake, WA (US); **Harry Reed Antipala**, Kailua, HI (US); **Kyle Christopher Maligro**, Kalaheo, HI (US)
- (73) Assignee: **Knekt Industries Ltd.**, Kailua, HI (US)
- (*) Notice: Subject to any disclaimer, the term of this patent is extended or adjusted under 35 U.S.C. 154(b) by 0 days.

2,949,838	A *	8/1960	Skalabrin	396/425
3,893,144	A	7/1975	Funderburk	
4,221,477	A *	9/1980	Prochnow et al.	396/425
4,727,390	A	2/1988	Brown	
5,081,478	A *	1/1992	Hayashida et al.	396/425
7,832,696	B2	11/2010	Goodman	
8,446,467	B2	5/2013	Tilton et al.	
2003/0201371	A1 *	10/2003	Zadok	248/276.1
2010/0202769	A1	8/2010	Polster	
2010/0277591	A1	11/2010	Kowalsky	
2013/0005401	A1	1/2013	Rosenhan et al.	

FOREIGN PATENT DOCUMENTS

GB	WO2012052732	A1	4/2012
WO	WO2013066728	A1	5/2013

* cited by examiner

Primary Examiner — Clayton E Laballe

Assistant Examiner — Dennis Hancock

(74) *Attorney, Agent, or Firm* — Ash Tankha; Lipton, Weinberger & Husick

(21) Appl. No.: **14/477,849**

(22) Filed: **Sep. 4, 2014**

(65) **Prior Publication Data**

US 2015/0063795 A1 Mar. 5, 2015

Related U.S. Application Data

(60) Provisional application No. 61/874,254, filed on Sep. 5, 2013.

(51) **Int. Cl.**
G03B 17/00 (2006.01)

G03B 17/56 (2006.01)

(52) **U.S. Cl.**
CPC **G03B 17/561** (2013.01); **G03B 17/563** (2013.01)

(58) **Field of Classification Search**
USPC 396/420, 425
See application file for complete search history.

(57) **ABSTRACT**

A device support and trigger apparatus includes a handle, a frame member attached to the handle, a cage member, and a triggering assembly including a trigger section and an actuation section. The cage member rigidly or pivotally connected to the frame member accommodates a device. The cage member can be rigidly positioned in an upright position or can be pivotally rotated to position the device in an upright position or an inverted position. The trigger section is pulled using one hand to allow the actuation section to contact and actuate an activation button of the device positioned in the upright position in front of the handle. A push rod assembly of the device support and trigger apparatus is pushed using one hand to push the trigger section to allow the actuation section to contact and actuate the activation button of the device positioned in the inverted position above the handle.

10 Claims, 22 Drawing Sheets

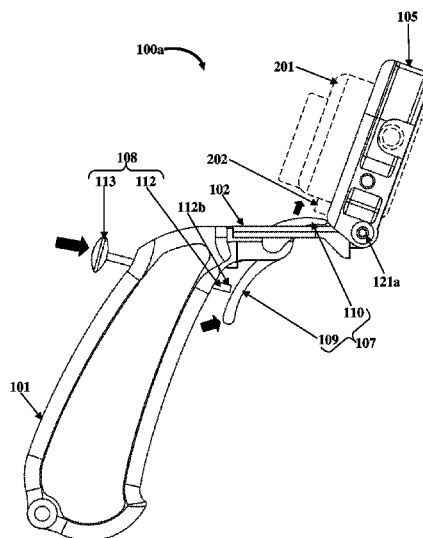

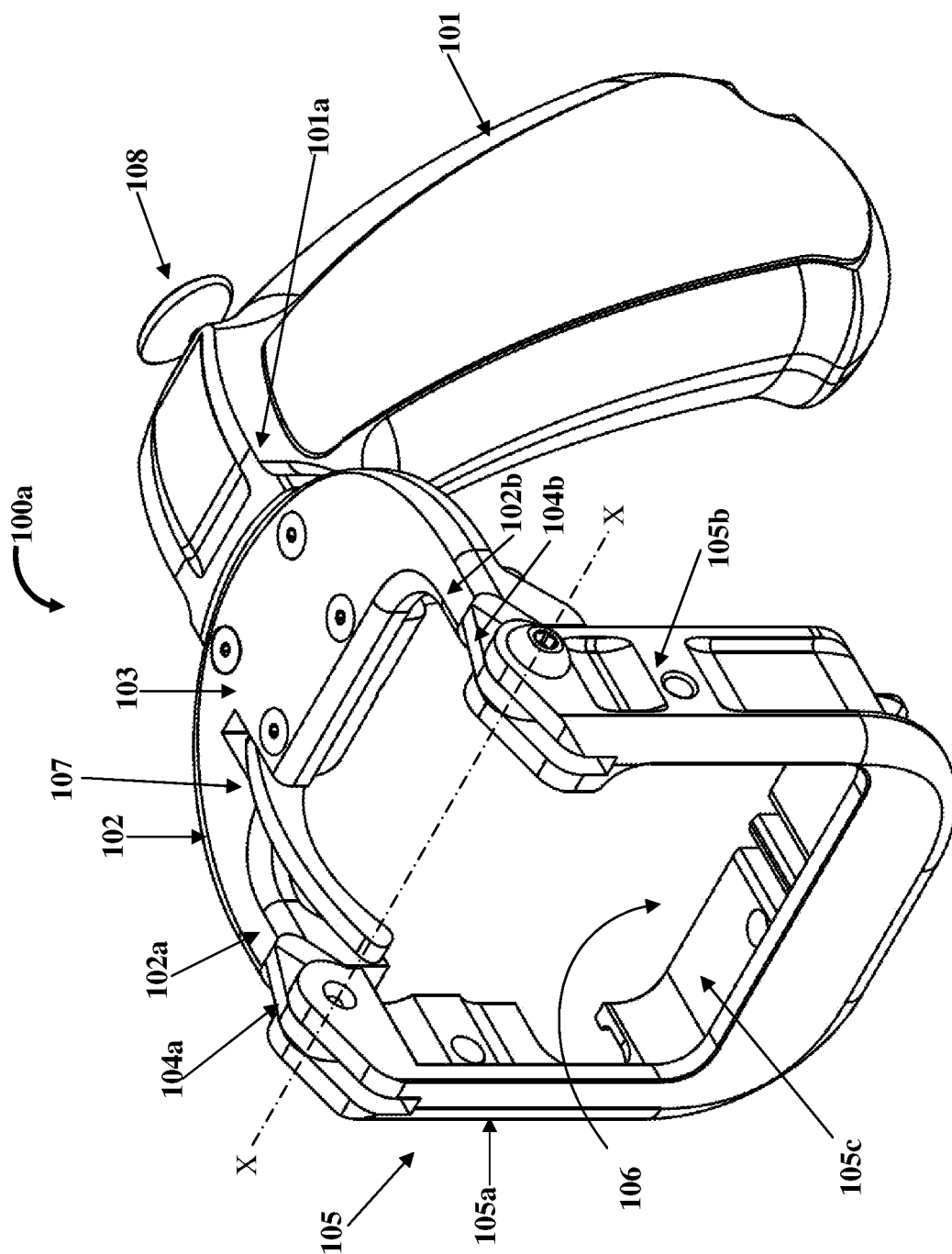

FIG. 1A

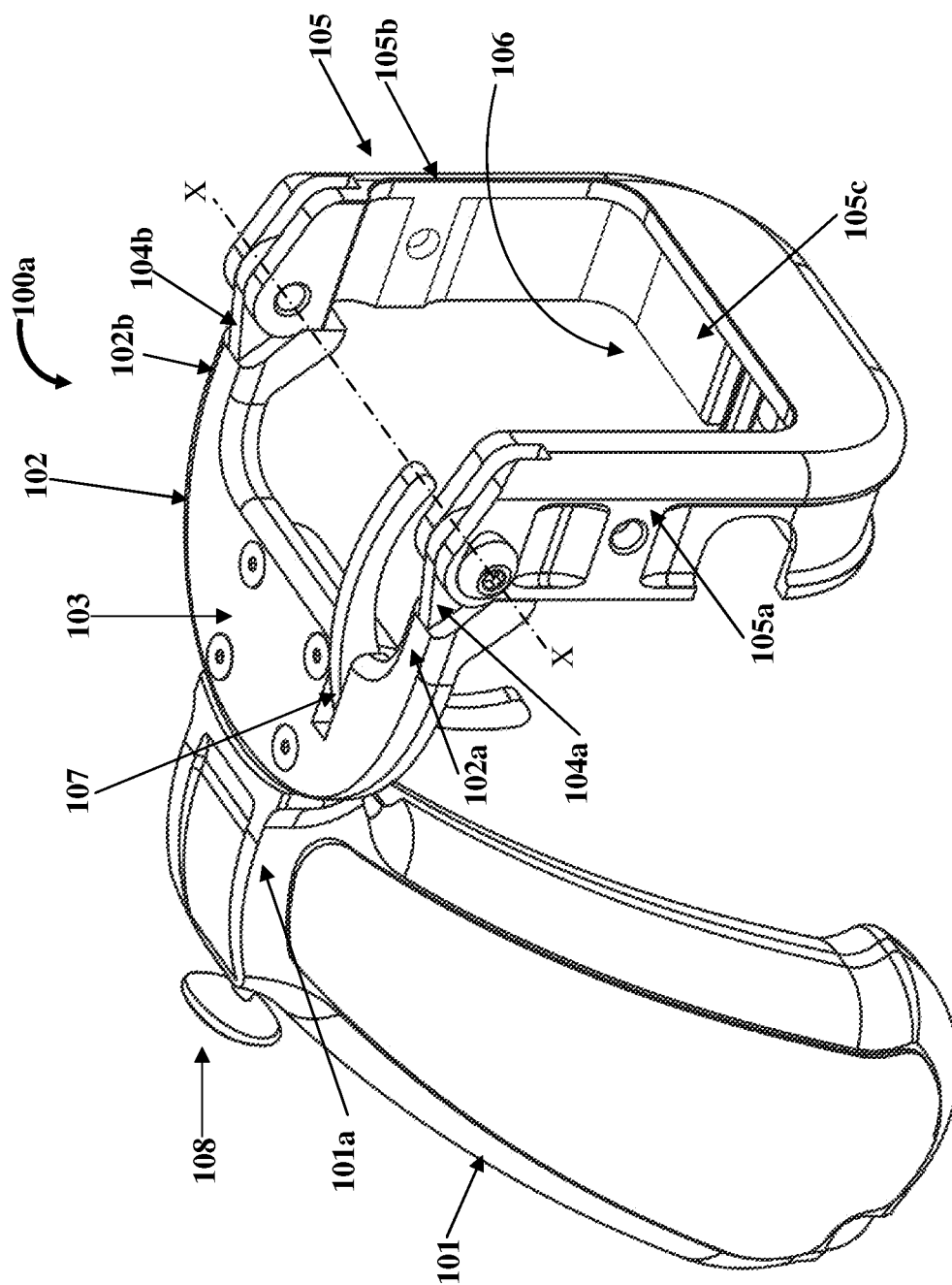

FIG. 1B

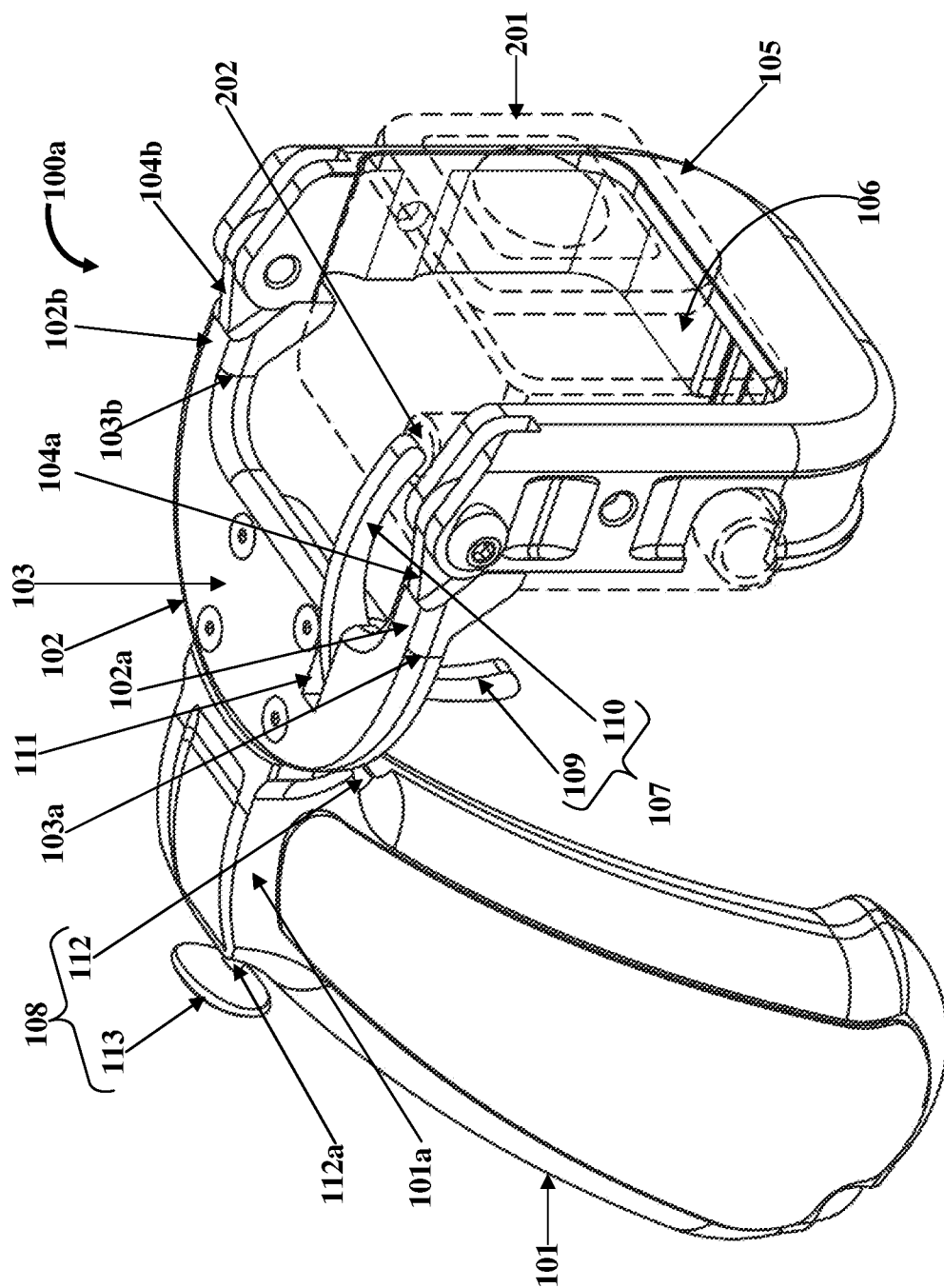

FIG. 2A

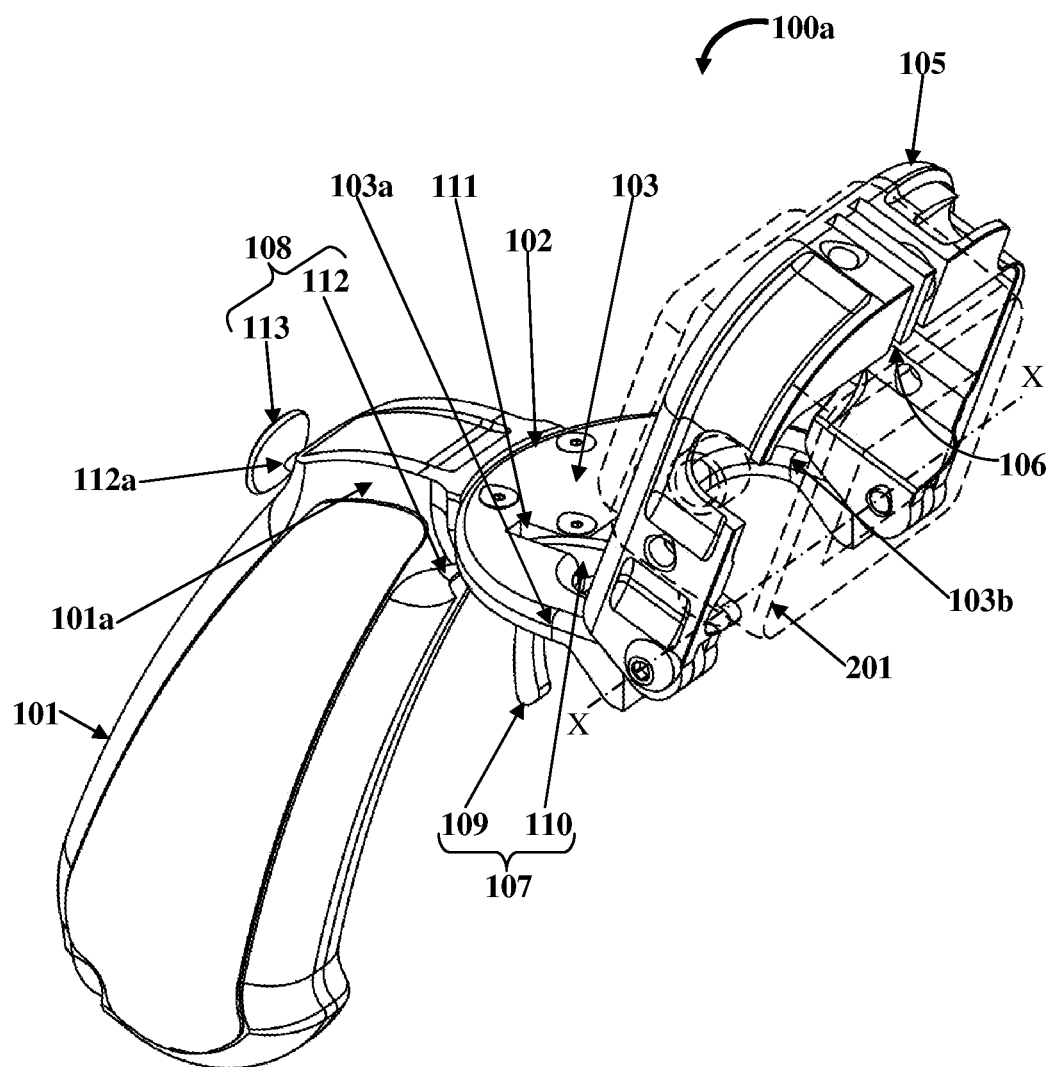

FIG. 2B

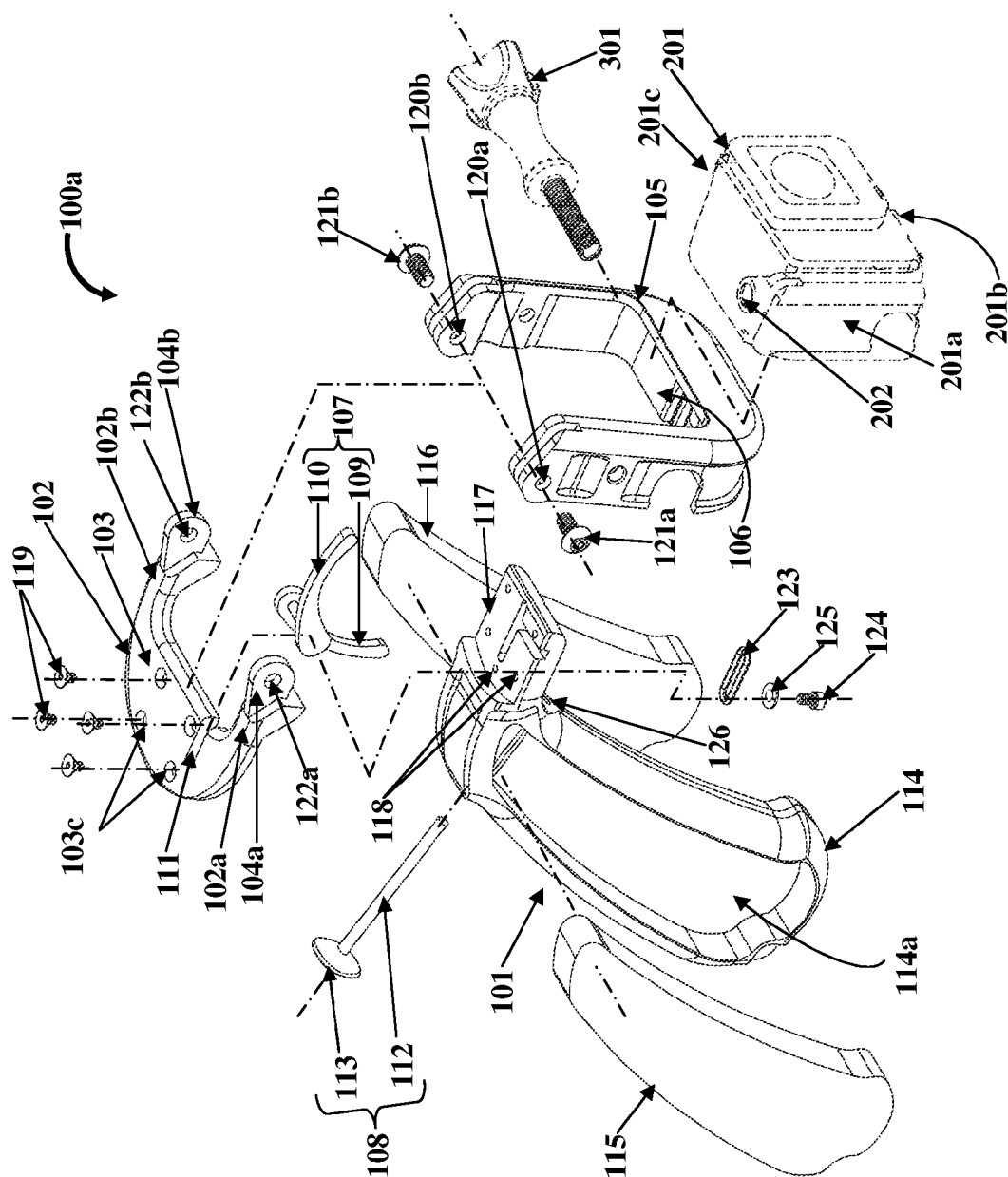

FIG. 3

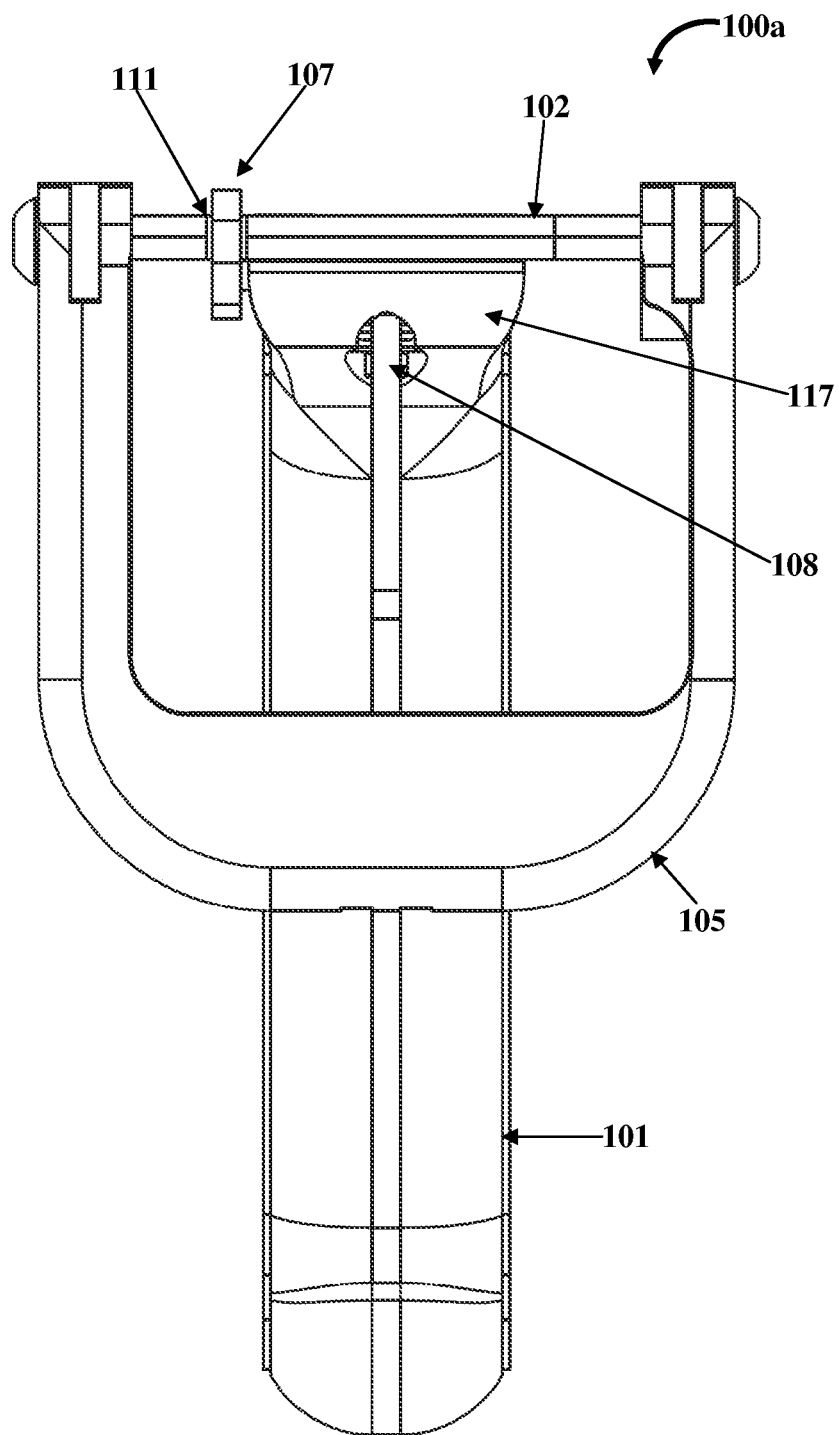

FIG. 4A

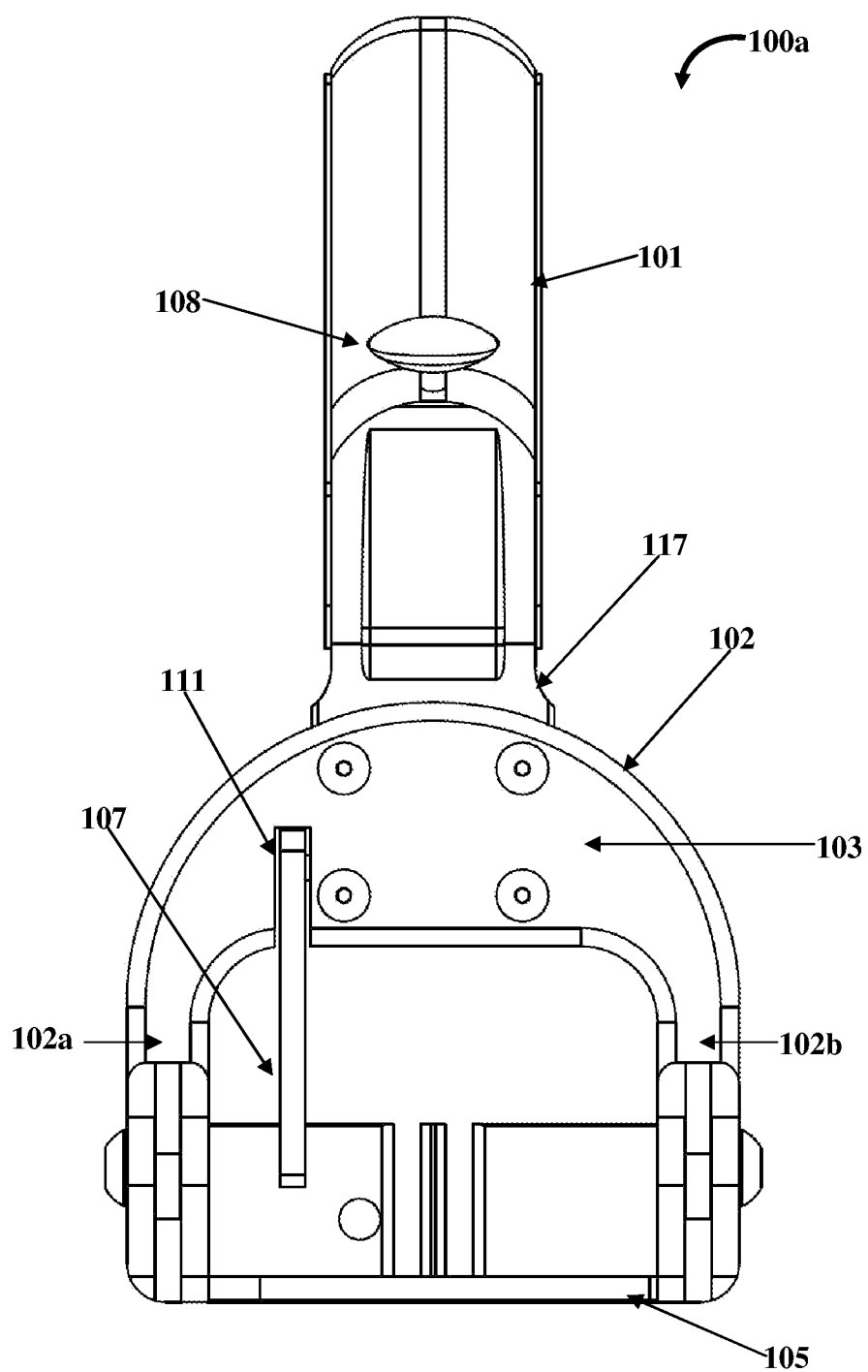

FIG. 4B

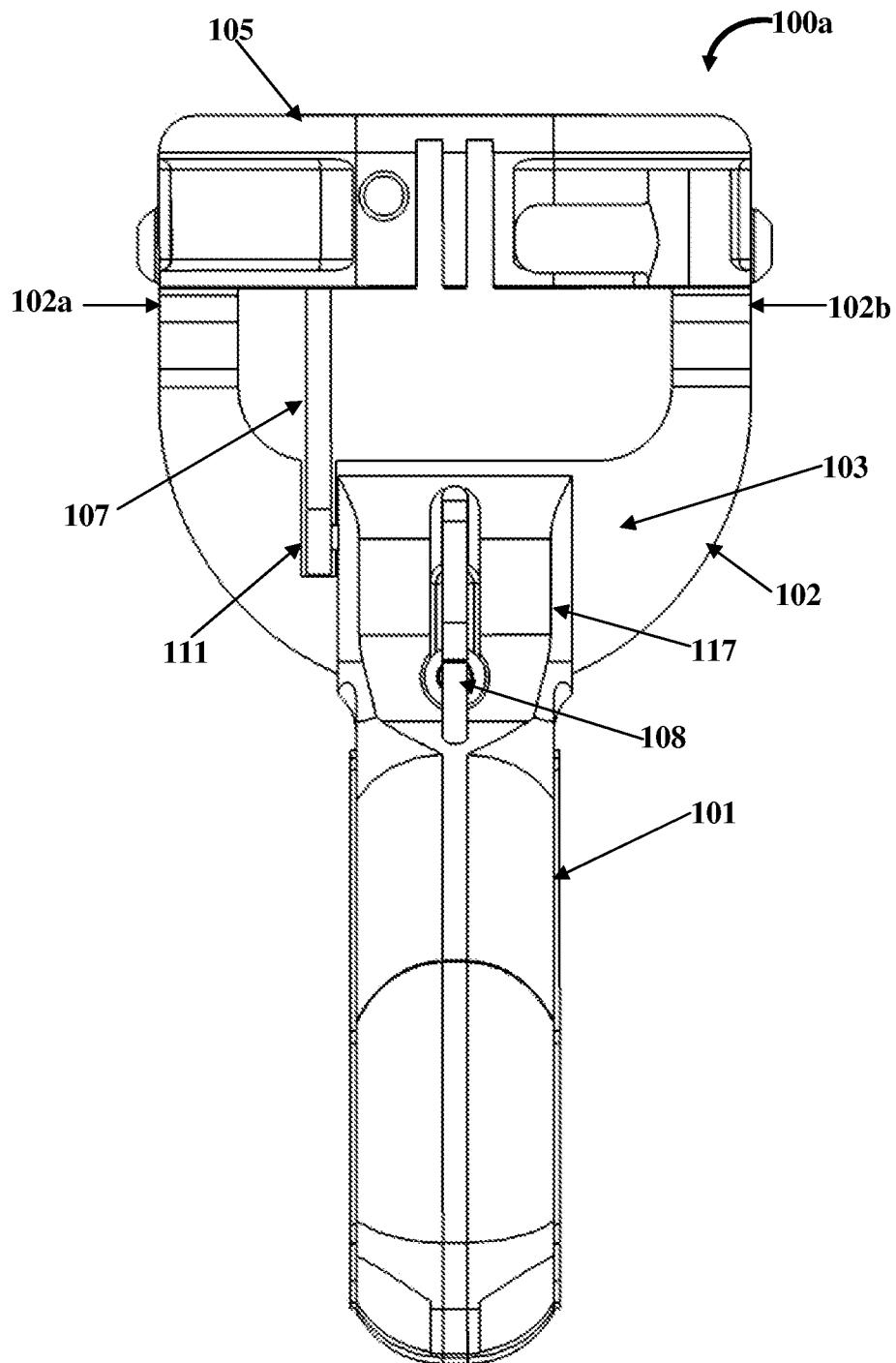

FIG. 4C

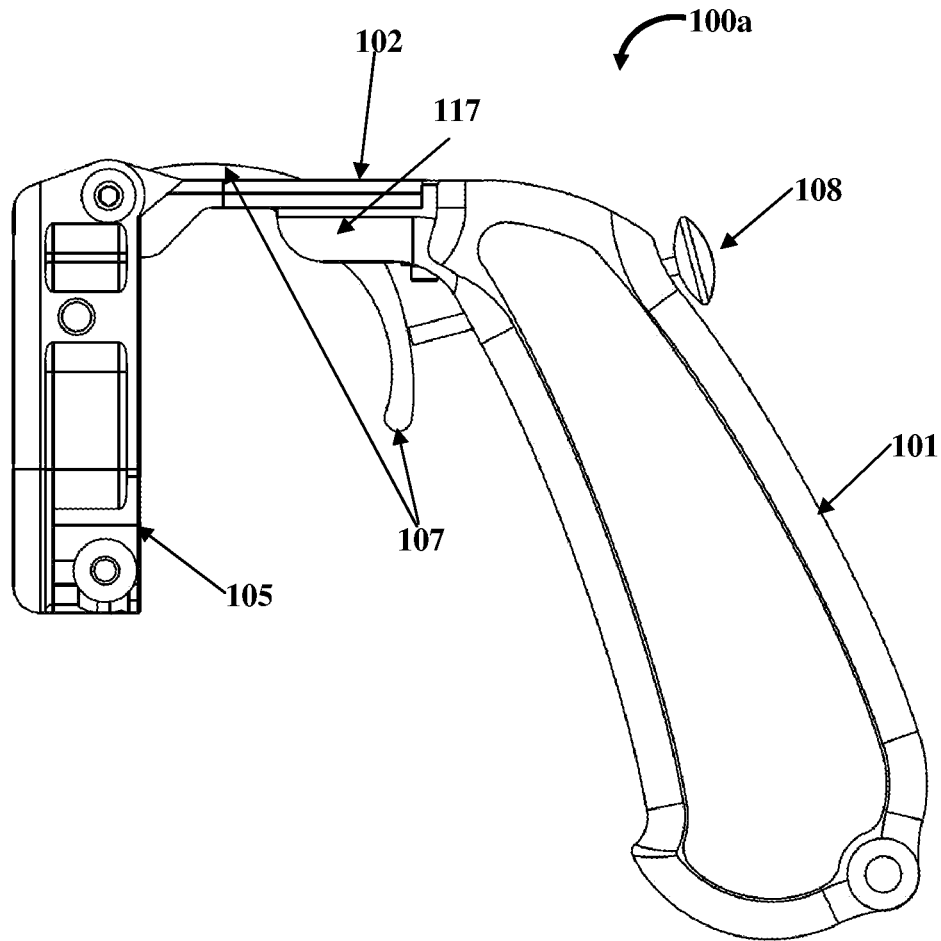

FIG. 4D

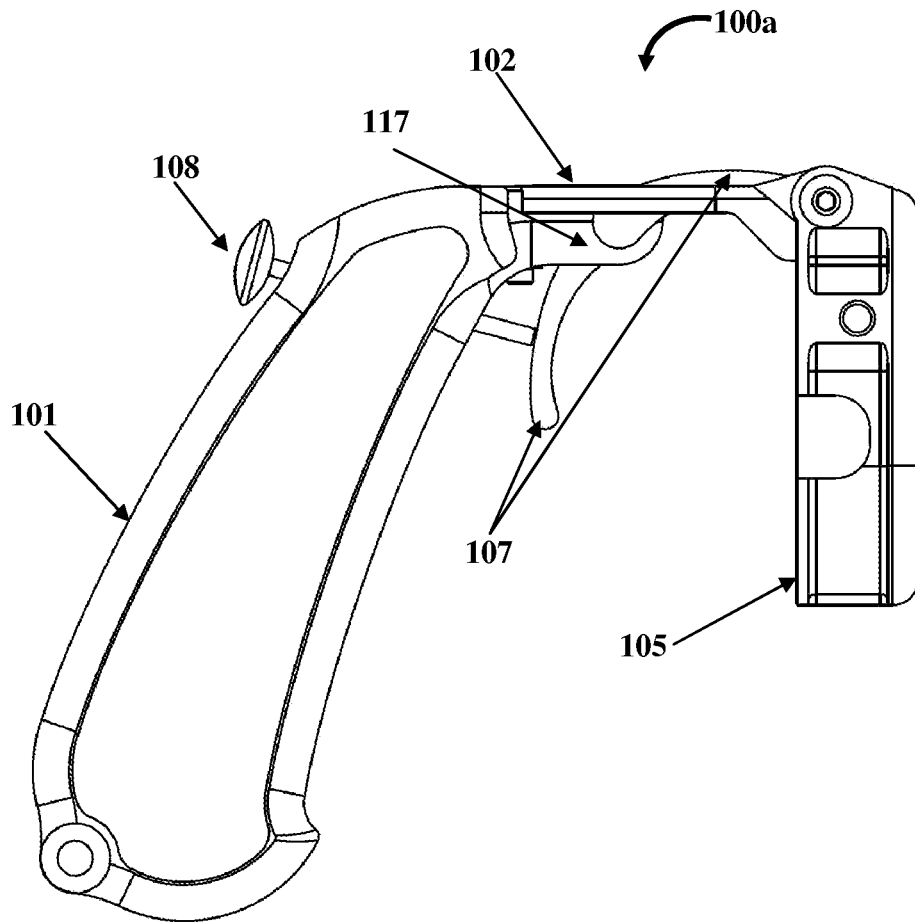

FIG. 4E

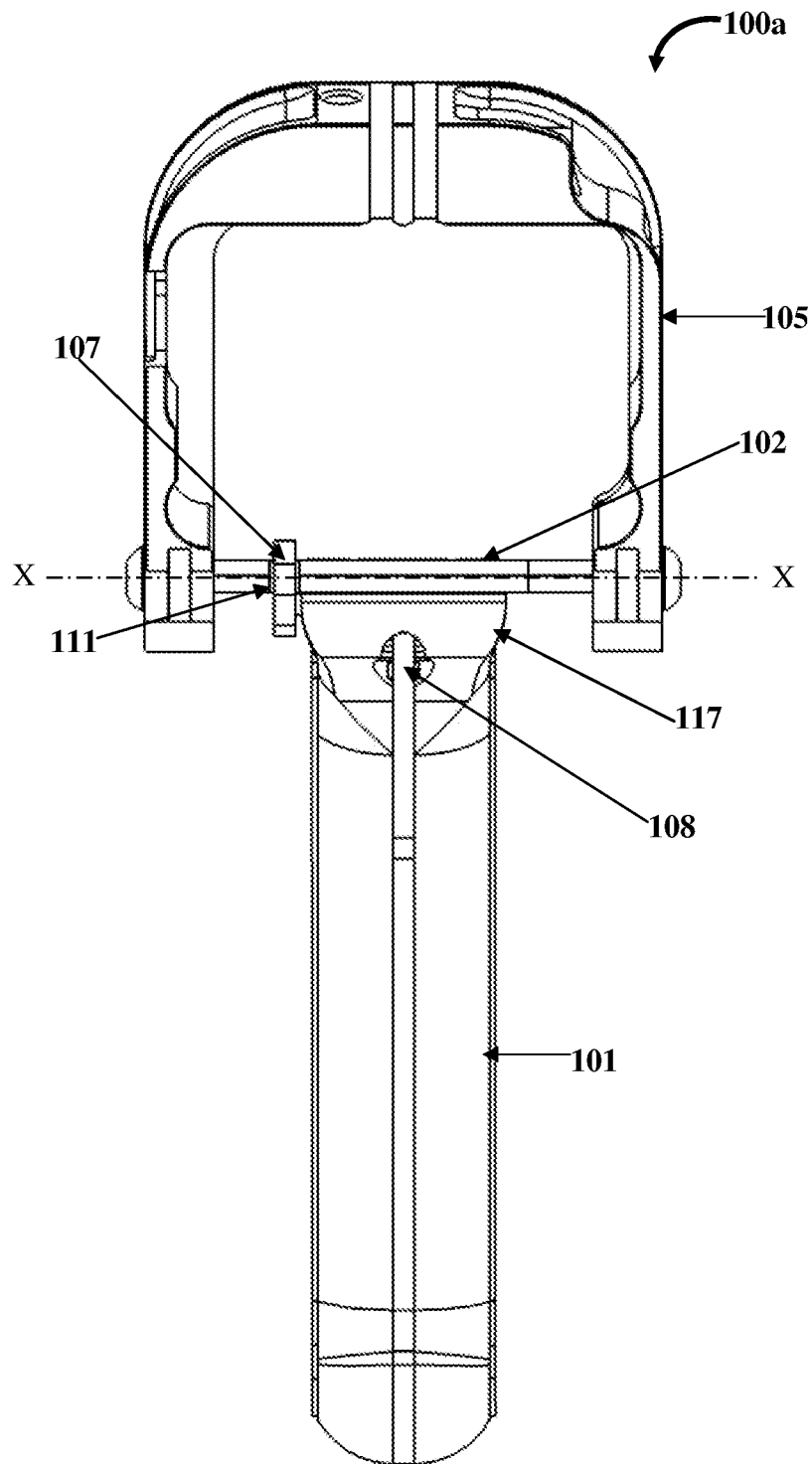

FIG. 4F

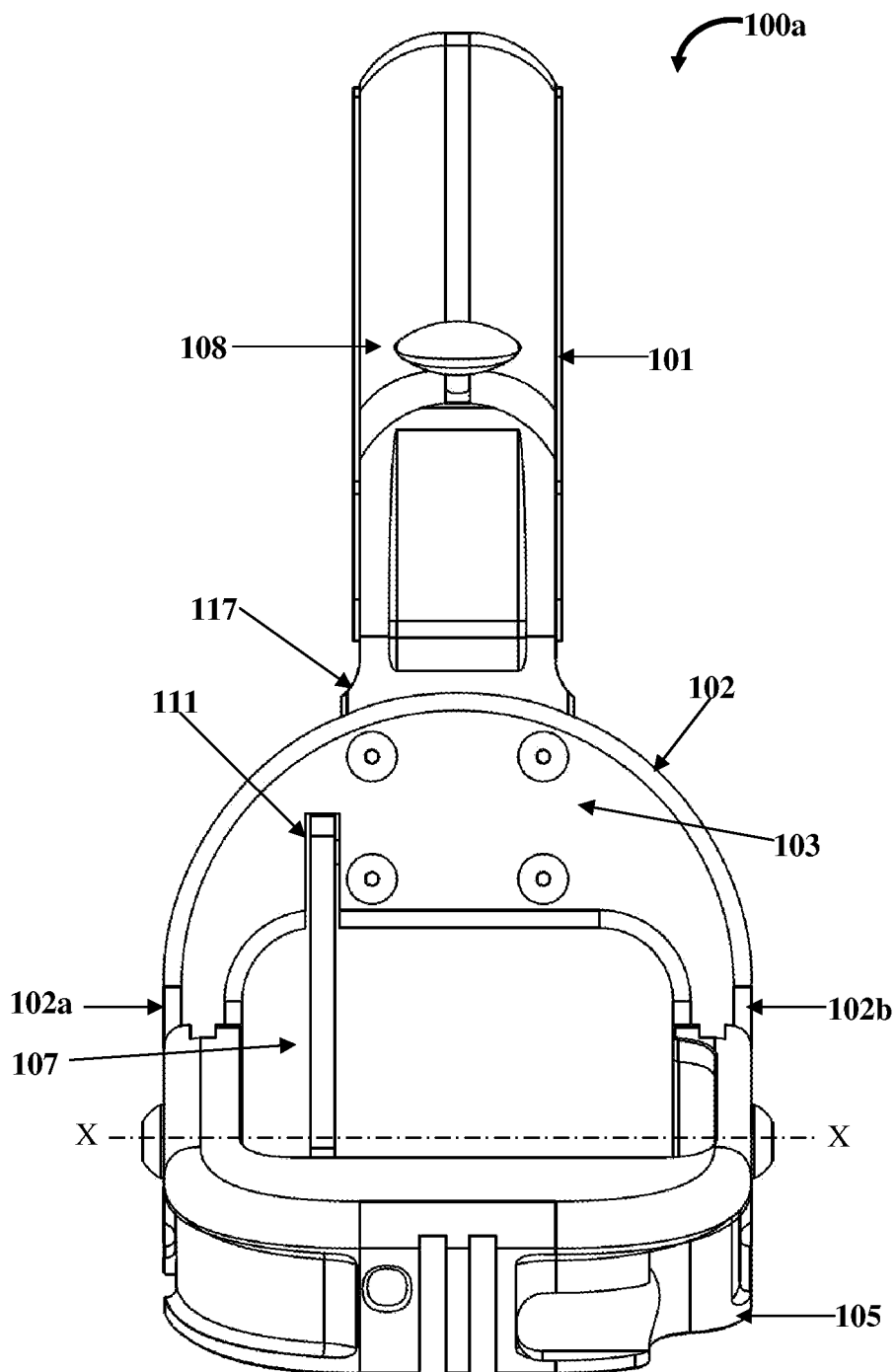

FIG. 4G

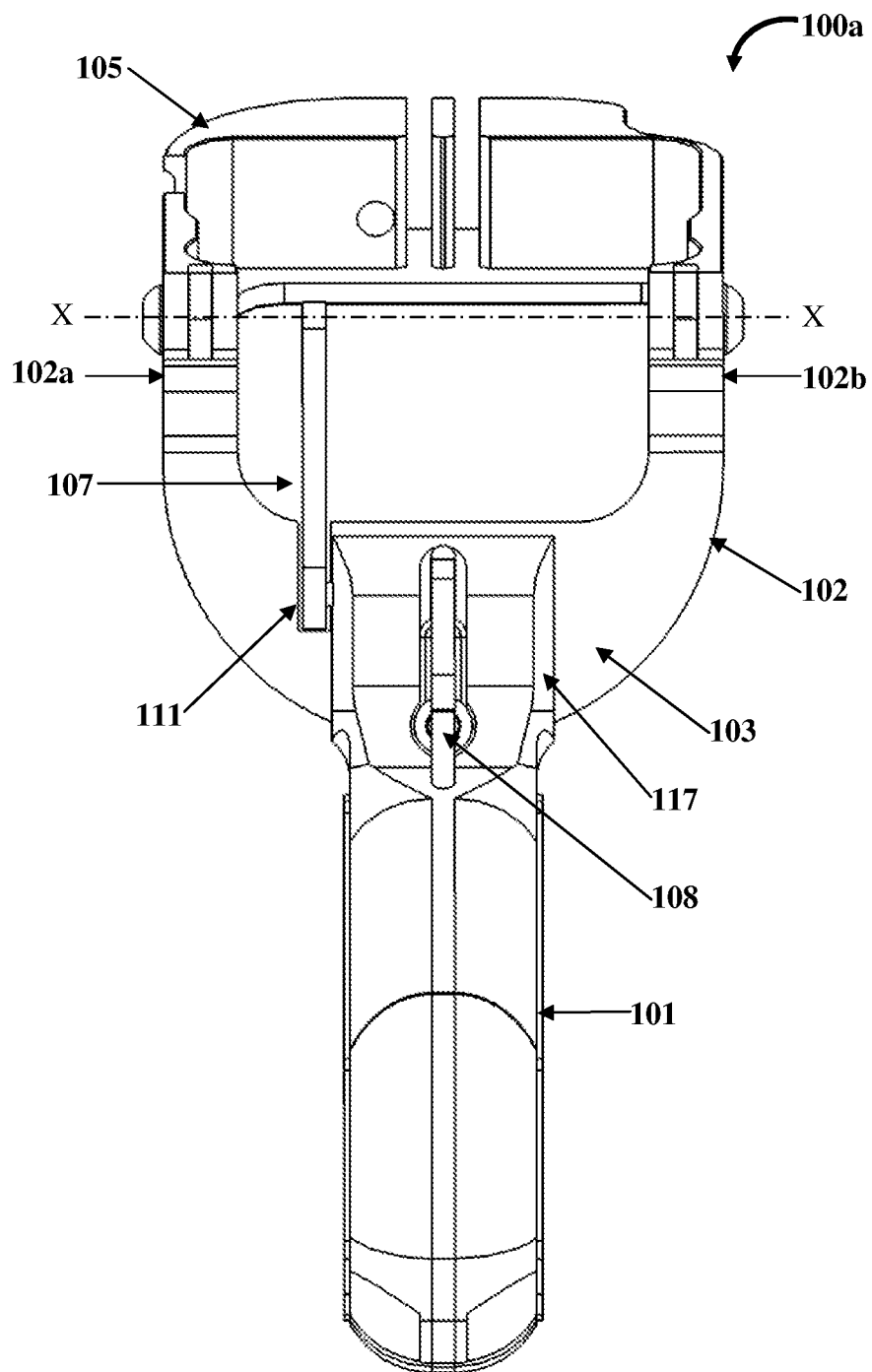

FIG. 4H

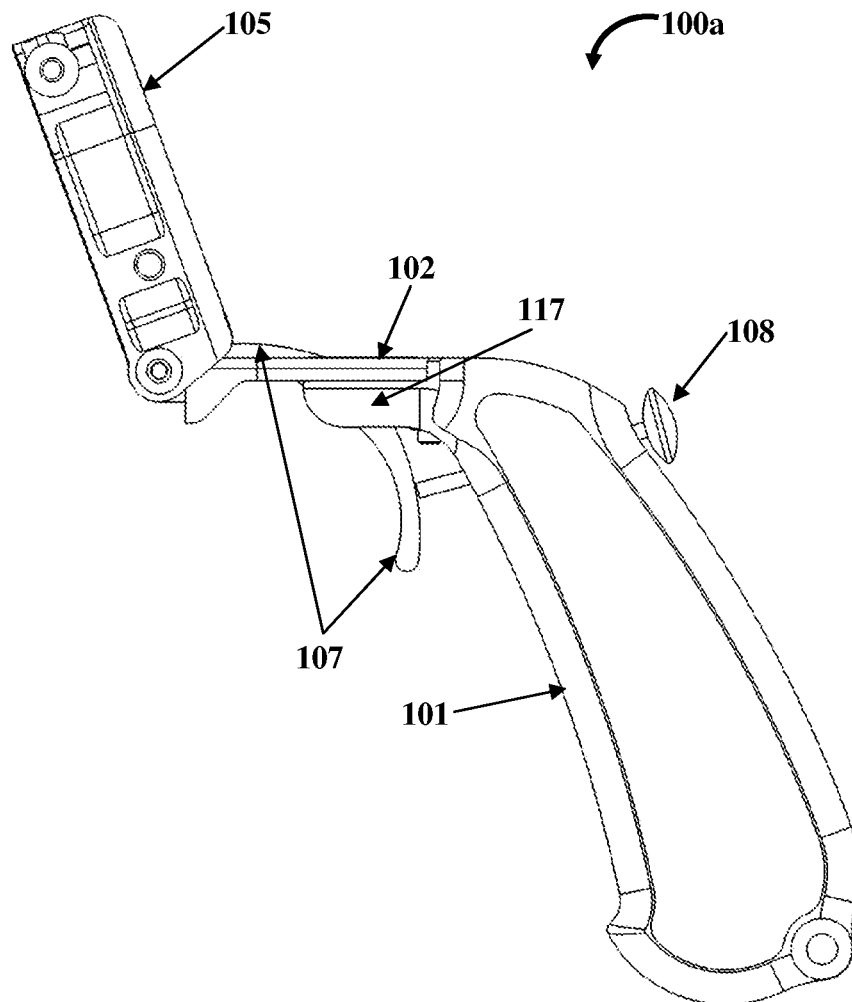

FIG. 4I

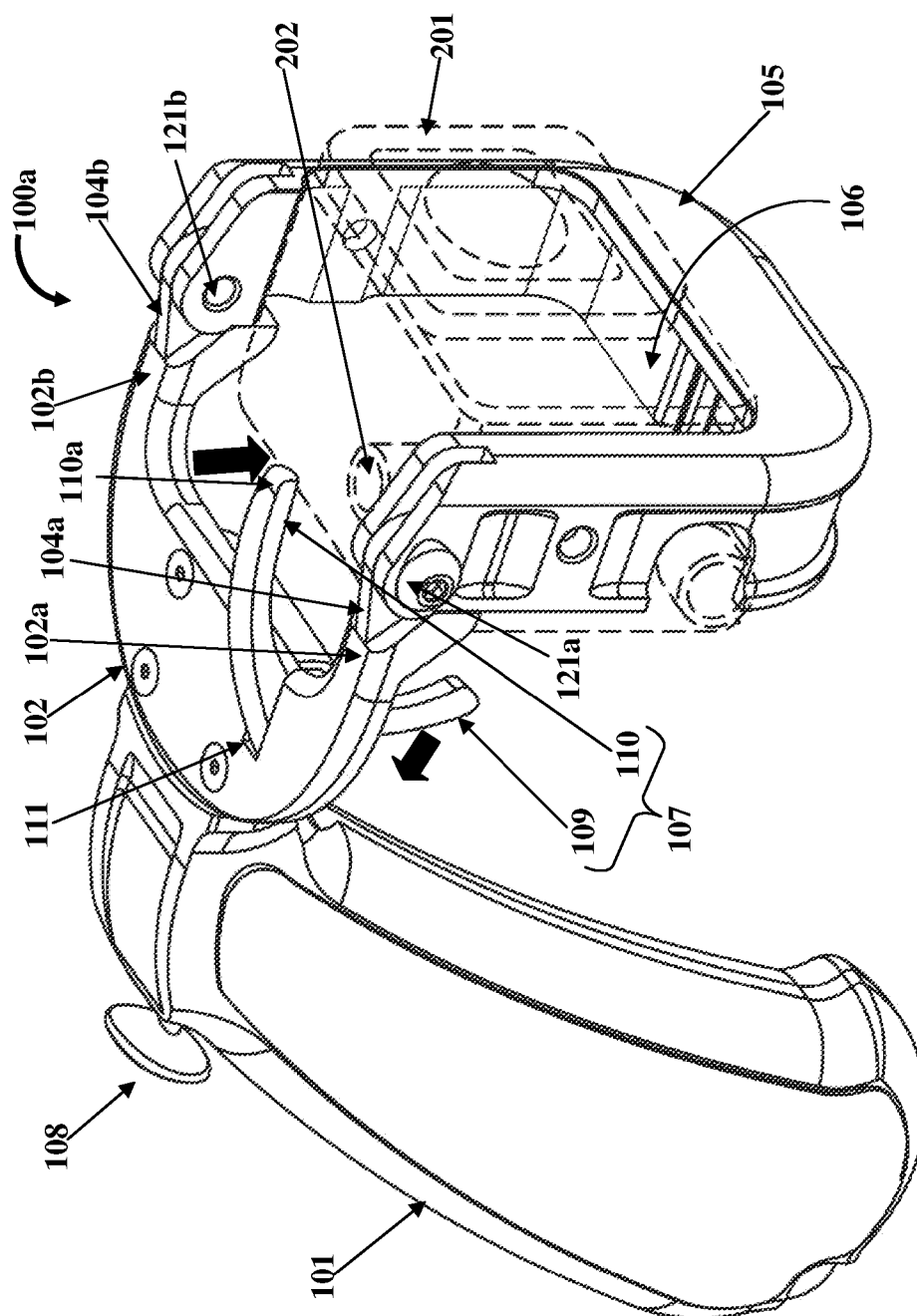

FIG. 5A

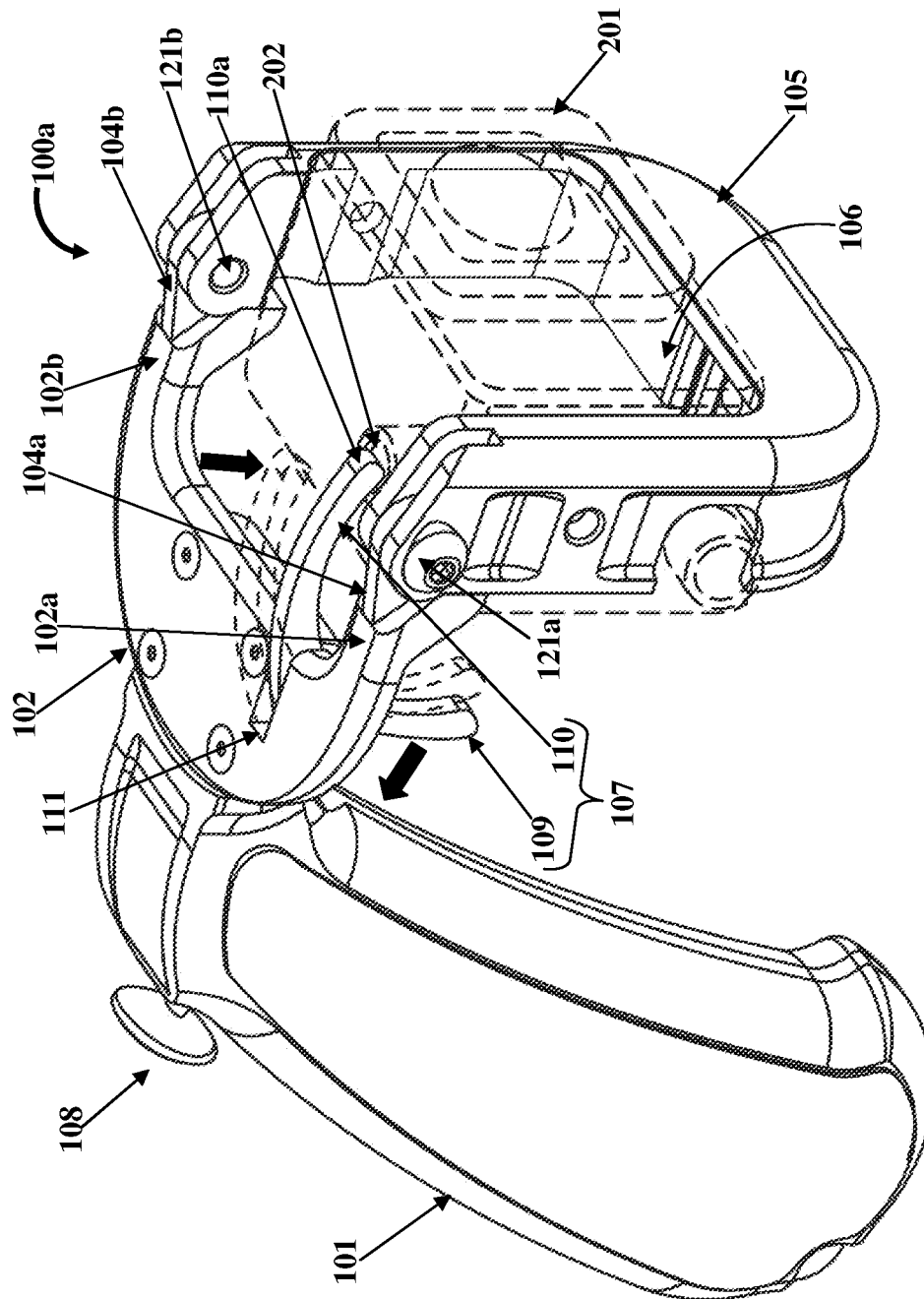

FIG. 5B

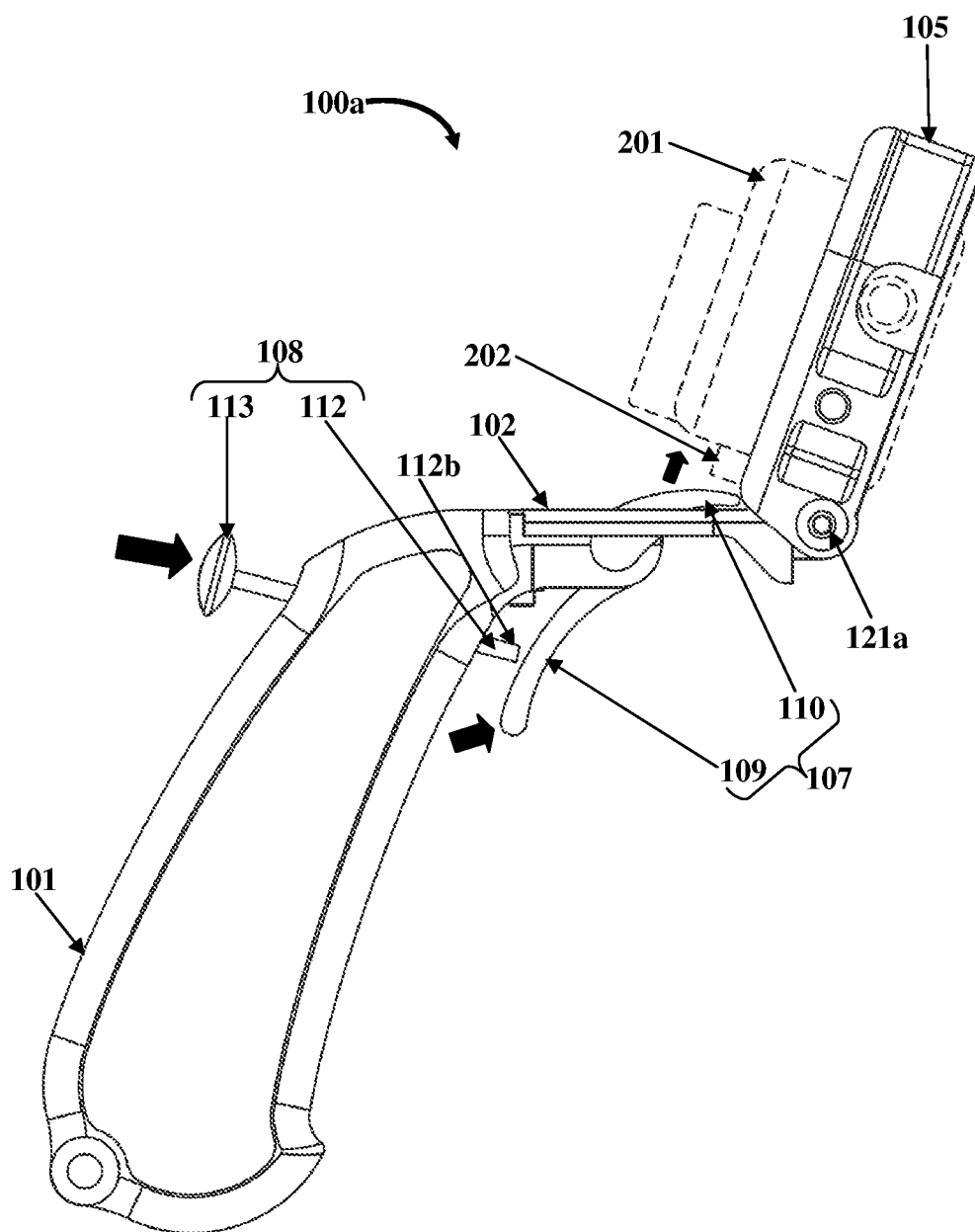

FIG. 6A

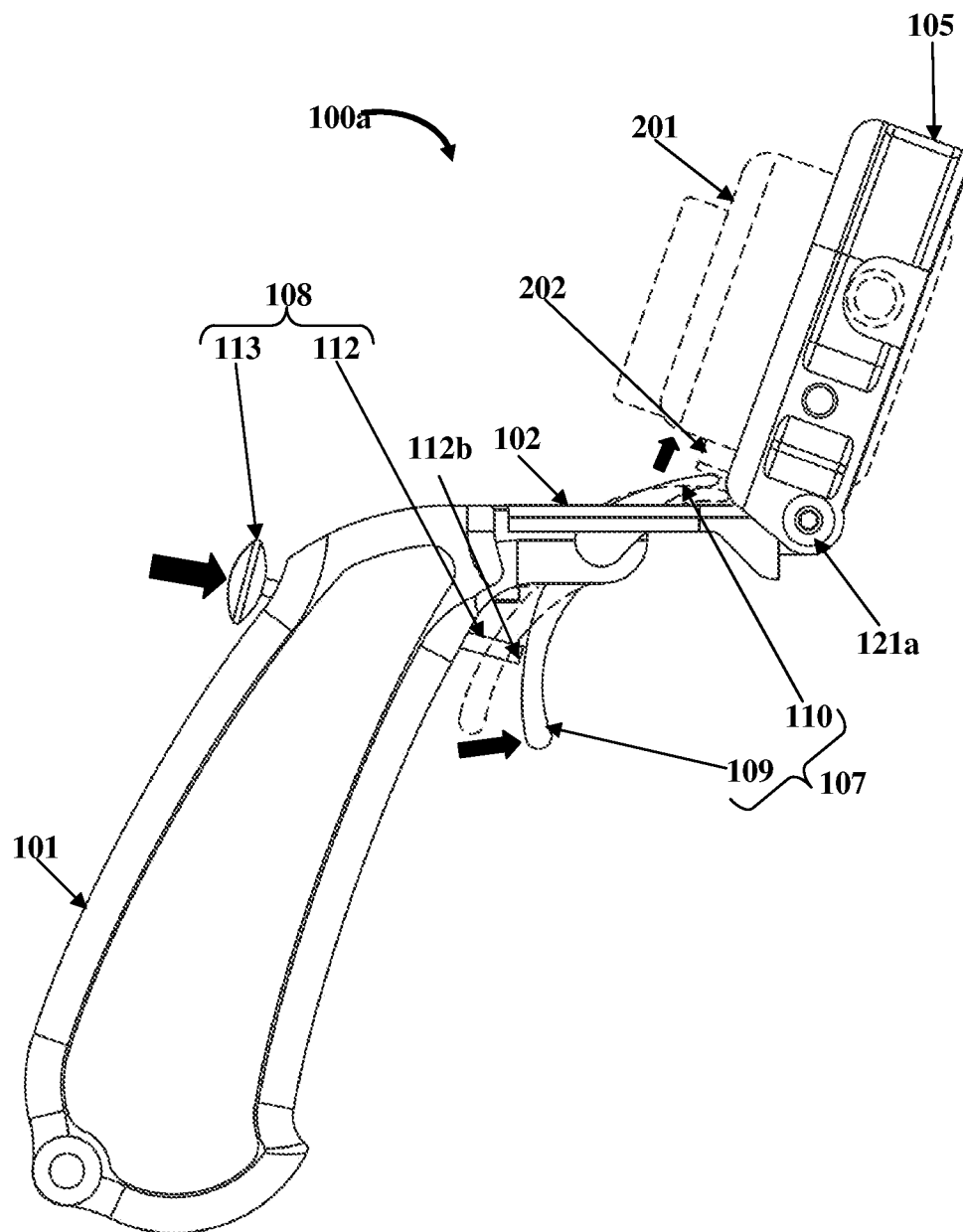

FIG. 6B

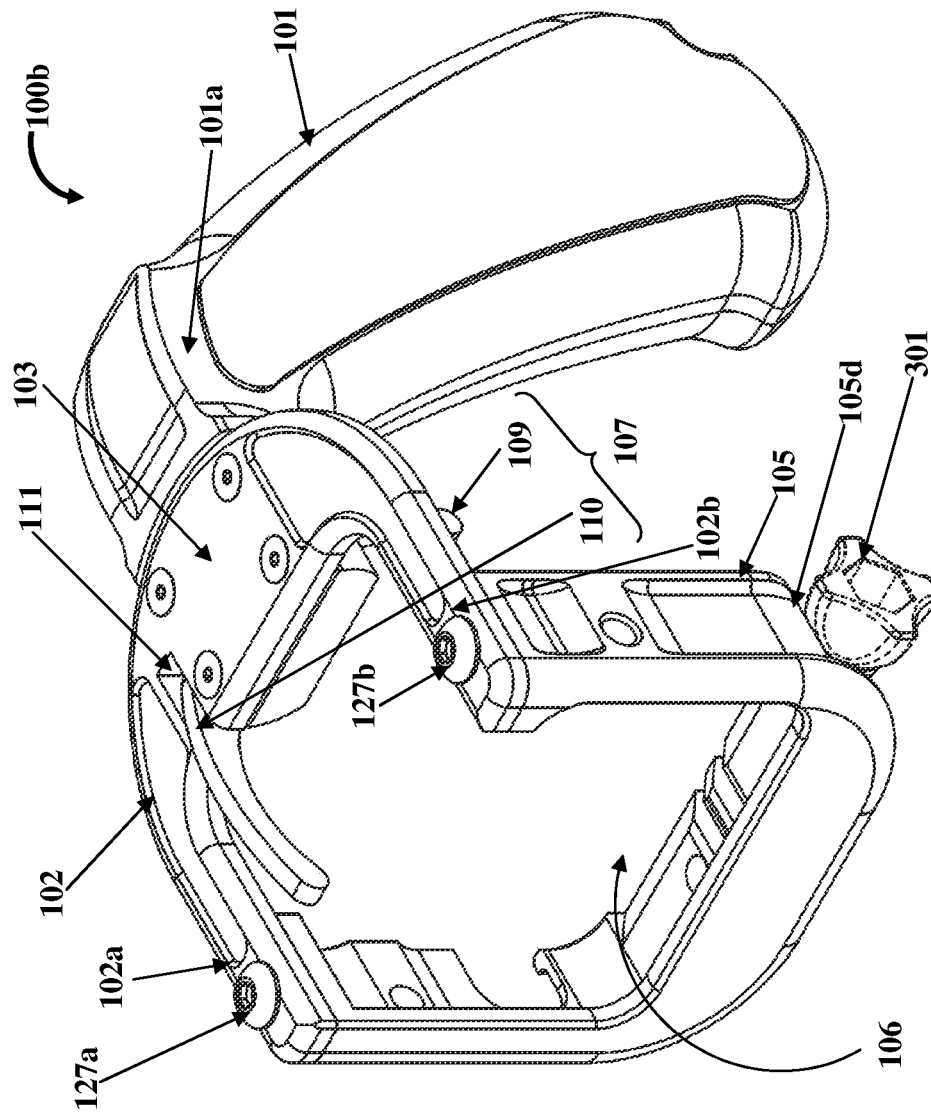

FIG. 7A

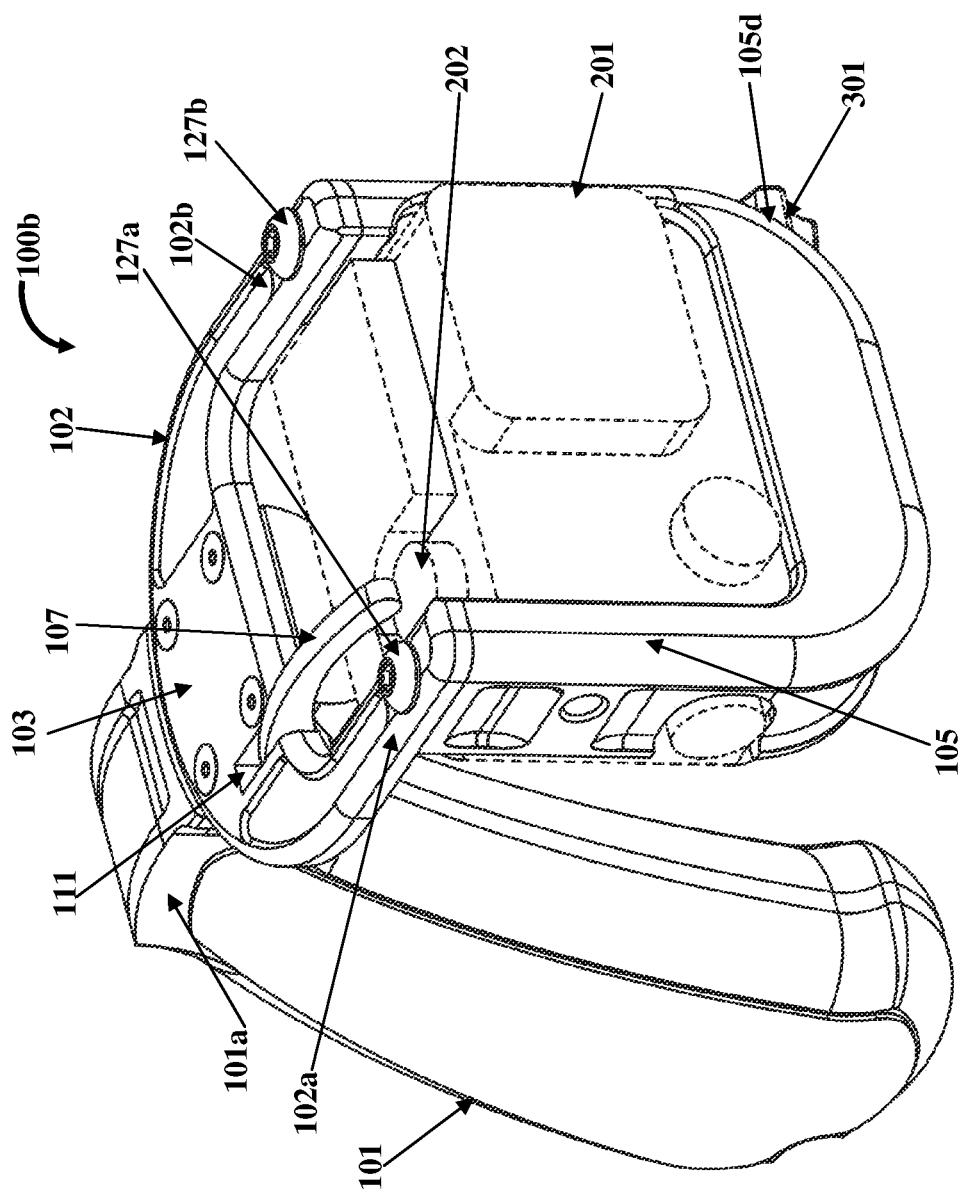

FIG. 7B

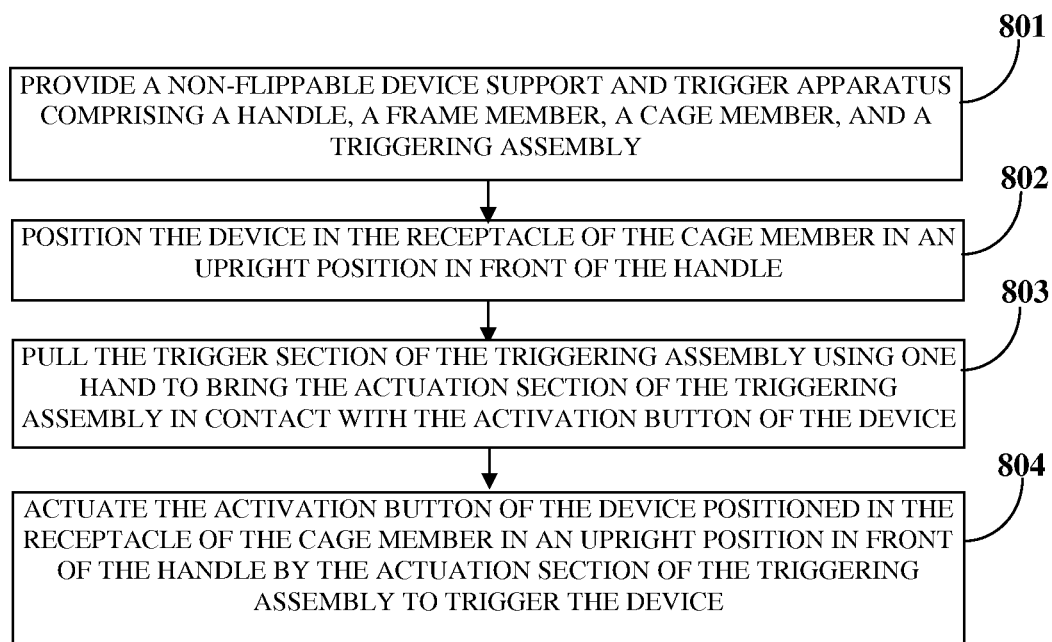

FIG. 8

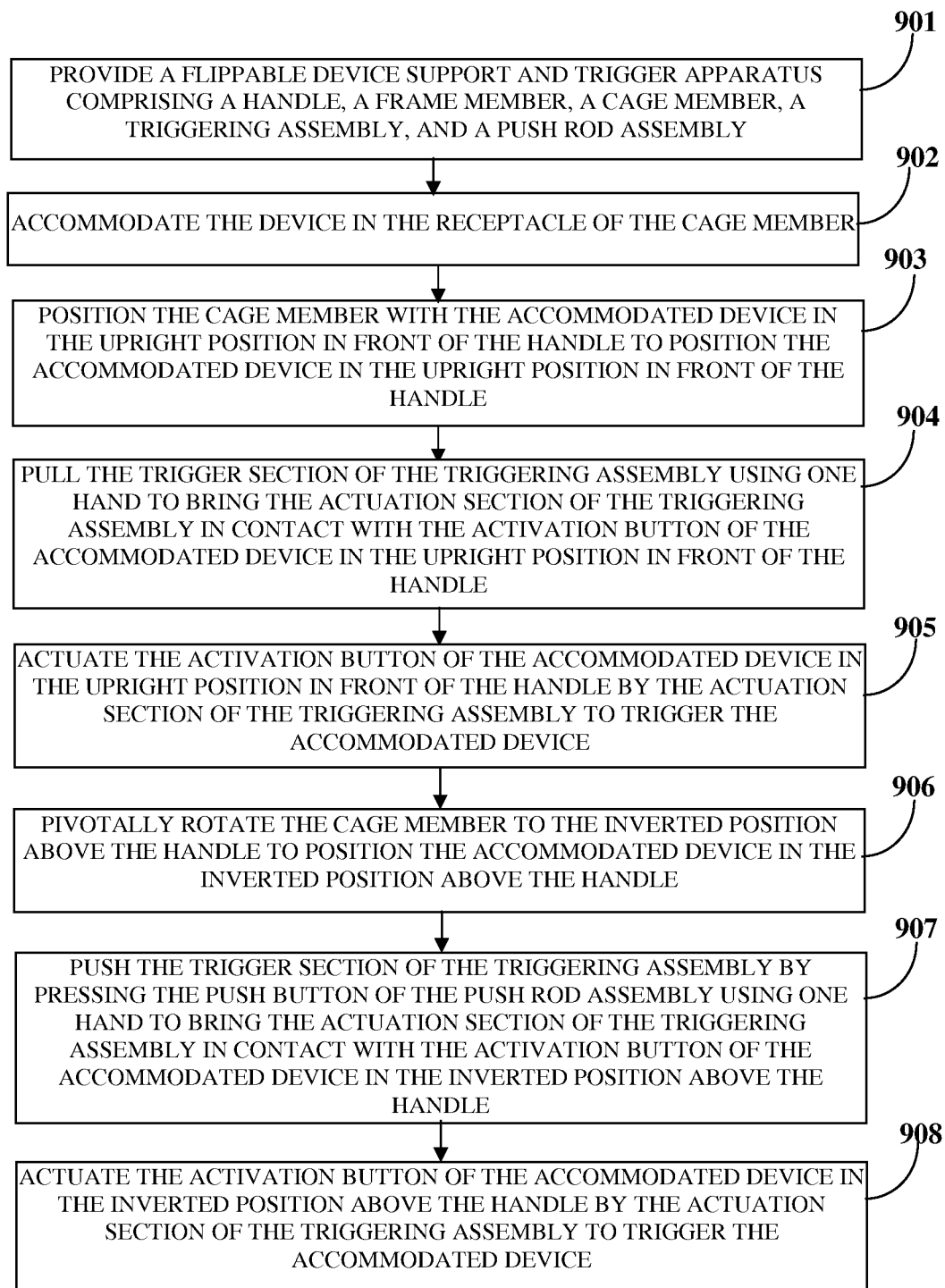

FIG. 9

1

DEVICE SUPPORT AND TRIGGER APPARATUS**CROSS REFERENCE TO RELATED APPLICATIONS**

This application claims priority to and the benefit of provisional patent application No. 61/874,254 titled "Handle and trigger assembly that enables one handed activation of the shutter button for GoPro Cameras and Housings", filed in the United States Patent and Trademark Office on Sep. 5, 2013. The specification of the above referenced patent application is incorporated herein by reference in its entirety.

BACKGROUND

Modern day cameras, for example, a GoPro® camera of GoPro, Inc., video cameras, etc., are compact and flexible enough to allow the cameras to be mounted on a variety of tripods and camera mounts. These cameras are generally housed in a housing of the camera mount and tightly held to the camera mount using a fastener. When a user uses such a camera in or outside of the housing of the camera mount, the user typically has to depress a shutter release button of the camera with one hand while holding the handle of the camera mount in the other hand. This makes it difficult for the user to control the timing for the activation of the shutter release button of the camera. Moreover, such a configuration makes it difficult for the user to properly frame a shot and to steadily focus the camera to capture photographs or videos. Furthermore, most camera mounts have their mounting sections positioned above a top section of the handle which makes it difficult for the user to balance the weight of the camera while taking a steady shot and to control electronic settings of the camera. The user may also wish to position the camera in an upright position to capture still images and/or moving images or videos of objects in front of them, or in an inverted position to capture self portrait still images and/or moving images or videos.

Hence, there is a long felt but unresolved need for a device support and trigger apparatus that can be held in one hand, that positions a device, for example, a camera in a housing in front of a handle to enable enhanced shot framing, positioning, balance, stability, and control, and that comprises a single pivot hinge trigger assembly for actuating an activation button of the device using the same one hand. Furthermore, there is a need for a device support and trigger apparatus that allows the device to be inverted to capture self portrait still images and/or moving images or videos with one hand.

SUMMARY OF THE INVENTION

This summary is provided to introduce a selection of concepts in a simplified form that are further disclosed in the detailed description of the invention. This summary is not intended to identify key or essential inventive concepts of the claimed subject matter, nor is it intended for determining the scope of the claimed subject matter.

The apparatus disclosed herein addresses the above stated needs for a device support and trigger apparatus that can be held in one hand, that positions a device, for example, a GoPro® camera of GoPro, Inc., in a housing in front of a handle to enable enhanced shot framing, positioning, balance, stability, and control, and that comprises a single pivot hinge trigger assembly for actuating an activation button of the device using the same one hand. The apparatus disclosed herein also allows the device to be inverted to capture self

2

portrait still images and/or moving images or videos with one hand. The device support and trigger apparatus disclosed herein does not require a user to modify electronic menu settings of the device in order for the device to function in a typical manner in multiple positions. The device support and trigger apparatus that allows the device to be triggered in an upright position and an inverted position is herein referred to as a "flippable device support and trigger apparatus". The flippable device support and trigger apparatus disclosed herein allows a user to capture still images and/or moving images or videos of objects or an environment in front of the user, and also self portrait still images and/or moving images or videos.

The flippable device support and trigger apparatus comprises a handle, a frame member, a cage member, a triggering assembly, and a push rod assembly. The frame member is fixedly attached to an upper end of the handle. The frame member comprises a support section and arms. The arms extend from opposing ends of the support section. The cage member is pivotally connected to the arms of the frame member. The cage member comprises a receptacle configured to accommodate a device, for example, a camera, a smart phone, etc. The cage member is configured to be positioned at a predefined angle with respect to the frame member and pivotally rotated to one of multiple positions, for example, an upright position in front of the handle, an inverted position above the handle, etc., to position the device, for example, in the upright position in front of the handle or in the inverted position above the handle. The triggering assembly is configured to operably communicate with the device accommodated in the receptacle of the cage member. The triggering assembly comprises a trigger section and an actuation section. The trigger section is pivotally connected to the actuation section at a notch positioned on the support section of the frame member. The actuation section extends above the receptacle of the cage member and is configured to contact an activation button of the device. A user pulls the trigger section of the triggering assembly using one hand to bring the actuation section of the triggering assembly in contact with the activation button of the device to actuate the activation button of the device when the cage member with the accommodated device is positioned in the upright position in front of the handle, for example, for capturing still images and/or moving images or videos of one or more objects or an environment in front of the user.

The push rod assembly comprises a rod member and a push button. The rod member is inserted through an opening in the handle to contact the trigger section of the triggering assembly. The push button is operably connected to a distal end of the rod member. The push button pushes the trigger section of the triggering assembly via the rod member when pressed using one hand, to bring the actuation section of the triggering assembly in contact with the activation button of the device to actuate the activation button of the device when the cage member with the accommodated device is positioned in the inverted position above the handle, for example, for capturing self portrait still images and/or moving images or videos. The triggering assembly can therefore actuate the activation button of the device not only in the upright position or down position, but also in the inverted or upward position, for example, for capturing still images and/or moving images or videos of one's self in an environment.

In an embodiment, the device support and trigger apparatus allows the device to be triggered only in an upright position to allow a user to capture still images and/or moving images or videos of objects or an environment in front of the user. This embodiment of the device support and trigger apparatus is

3

herein referred to as a “non-flippable device support and trigger apparatus”. The non-flippable device support and trigger apparatus is free of a push rod assembly. In this embodiment, the cage member is rigidly connected to the arms of the frame member in an upright position in front of the handle to accommodate the device in the upright position in front of the handle to allow a user to capture still images and/or moving images or videos of objects or an environment in front of the user using the triggering assembly.

BRIEF DESCRIPTION OF THE DRAWINGS

The foregoing summary, as well as the following detailed description of the invention, is better understood when read in conjunction with the appended drawings. For the purpose of illustrating the invention, exemplary constructions of the invention are shown in the drawings. However, the invention is not limited to the specific methods and structures disclosed herein. The description of a method step or a structure referenced by a numeral in a drawing carries over to the description of that method step or structure shown by that same numeral in any subsequent drawing herein.

FIG. 1A exemplarily illustrates a right side perspective view of a flippable device support and trigger apparatus.

FIG. 1B exemplarily illustrates a left side perspective view of the flippable device support and trigger apparatus.

FIG. 2A exemplarily illustrates a left side perspective view of the flippable device support and trigger apparatus, showing a cage member positioned in an upright position in front of a handle of the flippable device support and trigger apparatus and accommodating a device in the upright position in front of the handle.

FIG. 2B exemplarily illustrates a left side perspective view of the flippable device support and trigger apparatus, showing the cage member positioned in an inverted position above the handle and accommodating the device in the inverted position above the handle.

FIG. 3 exemplarily illustrates an exploded view of the flippable device support and trigger apparatus.

FIG. 4A exemplarily illustrates a front elevation view of the flippable device support and trigger apparatus, showing the cage member positioned in an upright position in front of the handle.

FIG. 4B exemplarily illustrates a top plan view of the flippable device support and trigger apparatus when the cage member is positioned in an upright position.

FIG. 4C exemplarily illustrates a bottom view of the flippable device support and trigger apparatus when the cage member is positioned in an upright position.

FIG. 4D exemplarily illustrates a right side elevation view of the flippable device support and trigger apparatus, showing the cage member positioned in an upright position in front of the handle.

FIG. 4E exemplarily illustrates a left side elevation view of the flippable device support and trigger apparatus, showing the cage member positioned in an upright position in front of the handle.

FIG. 4F exemplarily illustrates a front elevation view of the flippable device support and trigger apparatus, showing the cage member positioned in an inverted position above the handle.

FIG. 4G exemplarily illustrates a top plan view of the flippable device support and trigger apparatus when the cage member is positioned in an inverted position.

FIG. 4H exemplarily illustrates a bottom view of the flippable device support and trigger apparatus when the cage member is positioned in an inverted position.

4

FIG. 4I exemplarily illustrates a right side elevation view of the flippable device support and trigger apparatus, showing the cage member positioned in an inverted position above the handle.

FIGS. 5A-5B exemplarily illustrate left side perspective views of the flippable device support and trigger apparatus, showing actuation of a triggering assembly of the flippable device support and trigger apparatus for actuating an activation button of a device positioned in a receptacle of the cage member in an upright position in front of the handle.

FIGS. 6A-6B exemplarily illustrate left side elevation views of the flippable device support and trigger apparatus, showing actuation of the triggering assembly for actuating an activation button of a device positioned in the receptacle of the cage member in an inverted position above the handle.

FIGS. 7A-7B exemplarily illustrate perspective views of an embodiment showing a non-flippable device support and trigger apparatus.

FIG. 8 illustrates a method for triggering a device in an upright position using one hand.

FIG. 9 illustrates a method for triggering a device in an upright position and an inverted position using one hand.

DETAILED DESCRIPTION OF THE INVENTION

FIGS. 1A-1B exemplarily illustrate a right side perspective view and a left side perspective view of a flippable device support and trigger apparatus **100a** respectively. The flippable device support and trigger apparatus **100a** disclosed herein is used to mount and trigger a device **201** exemplarily illustrated in FIGS. 2A-2B. As used herein, the term “device” refers to any electronic device or mechanical device which has an external activation button. The device **201** is, for example, a camera such as a GoPro® camera of GoPro, Inc., a video camera, a mobile phone with an in-built camera, a smart phone, any still image or moving image capture device, etc.

The flippable device support and trigger apparatus **100a** disclosed herein comprises a handle **101**, a frame member **102**, a cage member **105**, a triggering assembly **107**, and a push rod assembly **108**. A user uses the handle **101** to hold the flippable device support and trigger apparatus **100a**. The handle **101** is configured to be held by the user in one hand. The frame member **102** is configured, for example, as an asymmetrical upper plate fixedly connected to an upper end **101a** of the handle **101**. The frame member **102** supports the cage member **105** in front of the handle **101**. The frame member **102** is a horizontal fitting element configured to pivotally connect the cage member **105** and the triggering assembly **107**. The cage member **105** is configured, for example, as a flip cage and is pivotally connected to the arms **102a** and **102b** of the frame member **102** via hinge elements **104a** and **104b** respectively. The arms **102a** and **102b** of the frame member **102** extend from a support section **103** of the frame member **102**. The cage member **105** pivotally rotates about a pivotal axis X-X. The cage member **105** comprises opposing walls **105a** and **105b** and a base section **105c** that define a receptacle **106**. The device **201** is mounted in the receptacle **106** of the cage member **105**. The opposing walls **105a** and **105b** and the base section **105c** of the cage member **105** surround the perimeter of the device **201** on three sides **201a**, **201b**, and **201c** of the device **201** exemplarily illustrated in FIG. 3. The triggering assembly **107** triggers an external activation button **202** exemplarily illustrated in FIG. 2A, for example, a shutter release button of the device **201**. The push rod assembly **108** is inserted through the handle **101** and is in communication with the triggering assembly **107** to actuate the triggering assembly **107** in an opposing direction

5

when compared to a typical triggering action of the triggering assembly 107 as disclosed in the detailed description of FIGS. 2A-2B, FIGS. 5A-5B, and FIGS. 6A-6B.

FIG. 2A exemplarily illustrates a left side perspective view of the flippable device support and trigger apparatus 100a, showing a cage member 105 positioned in an upright position in front of the handle 101 and accommodating a device 201, for example, a camera in the upright position in front of the handle 101. As used herein, "upright position" refers to a typical vertical position of the cage member 105 or the device 201, for example, a camera with a lens of the camera facing away from the user towards an object in front of the user and the lens. FIG. 2B exemplarily illustrates a left side perspective view of the flippable device support and trigger apparatus 100a, showing the cage member 105 positioned in an inverted position or in a flipped orientation above the handle 101 and accommodating the device 201 in the inverted position above the handle 101. As used herein, "inverted position" refers to an angled or flipped position of the cage member 105 or the device 201, for example, a camera, where the cage member 105 or the device 201 is turned or flipped to an angle in the range of, for example, about 225° to about 270° with respect to the frame member 102, to face a user such that the lens of the camera faces towards the user while the user holds the camera. The frame member 102 is fixedly attached to the upper end 101a of the handle 101. The frame member 102 comprises a support section 103 and arms 102a and 102b as exemplarily illustrated in FIG. 2A. The arms 102a and 102b of the frame member 102 extend from opposing ends 103a and 103b of the support section 103 of the frame member 102 respectively.

The cage member 105 is pivotally connected to the arms 102a and 102b of the frame member 102. The cage member 105 comprises a receptacle 106 configured to accommodate the device 201. The cage member 105 is configured to be positioned at a predefined angle with respect to the frame member 102. For example, in the upright position, the cage member 105 is positioned at 90° with respect to the frame member 102. In another example, in the inverted position, the cage member 105 is positioned in the range of about 225° to about 270° with respect to the frame member 102. The cage member 105 is further configured to be pivotally rotated about the pivotal axis X-X to one of multiple positions, for example, the inverted position above the handle 101, the upright position in front of the handle 101, etc., to position the device 201, for example, in the inverted position above the handle 101 as exemplarily illustrated in FIG. 2B, or in the upright position in front of the handle 101 as exemplarily illustrated in FIG. 2A.

The triggering assembly 107 is configured to operably communicate with the device 201 accommodated in the receptacle 106 of the cage member 105. The triggering assembly 107 comprises a trigger section 109 and an actuation section 110. The trigger section 109 is pivotally connected to the actuation section 110 at a notch 111 positioned on the support section 103 of the frame member 102. The pivotal connection between the trigger section 109 and the actuation section 110 provides a single pivot point activation mechanism for activating the device 201 in two positions, that is, in the upright position and the inverted position. The actuation section 110 of the triggering assembly 107 extends above the receptacle 106 of the cage member 105 and is configured to contact an activation button 202 of the device 201. The trigger section 109 of the triggering assembly 107 is configured to be pulled using one hand to bring the actuation section 110 of the triggering assembly 107 in contact with the activation button 202 of the device 201 to actuate the activation

6

button 202 of the device 201 when the cage member 105 with the accommodated device 201 is positioned in the upright position in front of the handle 101 as exemplarily illustrated in FIG. 2A.

The push rod assembly 108 comprises a rod member 112 and a push button 113. The rod member 112 is inserted through an opening 126 in the handle 101 exemplarily illustrated in FIG. 3, to contact the trigger section 109 of the triggering assembly 107. The push button 113 is operably connected to one end 112a of the rod member 112. The push button 113 is configured to push the trigger section 109 of the triggering assembly 107 via the rod member 112 when pressed using one hand to bring the actuation section 110 of the triggering assembly 107 in contact with the activation button 202 of the device 201 to actuate the activation button 202 of the device 201 when the cage member 105 with the accommodated device 201 is positioned in the inverted position above the handle 101.

The flippable device support and trigger apparatus 100a disclosed herein therefore allows the device 201 to be triggered in two positions, for example, by pulling of the trigger section 109 of the triggering assembly 107 using an index finger of one hand when the cage member 105 with the accommodated device 201 is in the upright position, and by the pushing of the push rod assembly 108 using the thumb of the same one hand when the cage member 105 with the accommodated device 201 is in the inverted position. In an embodiment, the device 201 can be triggered in one or both positions, for example, for capturing still images and/or moving images or videos in one or both positions.

FIG. 3 exemplarily illustrates an exploded view of the flippable device support and trigger apparatus 100a. In an embodiment, the handle 101 of the flippable device support and trigger apparatus 100a comprises a handle frame 114, a first segment 115, and a second segment 116. The first segment 115 is, for example, a left handle insert, and the second segment 116 is, for example, a right handle insert. The first segment 115 and the second segment 116 are adjoined to each other within a space 114a defined in the handle frame 114. The handle 101 is, for example, of a generally oblong shape. In an embodiment, the flippable device support and trigger apparatus 100a disclosed herein further comprises an intermediate member 117 fixedly attached to and extending from the handle 101. The intermediate member 117 comprises one or more through holes 118 to fixedly attach to the frame member 102 using one or more fastening members 119, for example, #4-40×7/16" inch stainless steel flat head cap screws. The frame member 102 is positioned on the intermediate member 117, and the fastening members 119 are first inserted into the through holes 103c of the frame member 102 and then through the through holes 118 of the intermediate member 117 to connect the frame member 102 to the intermediate member 117. In an embodiment, the frame member 102 comprising the support section 103 and the arms 102a and 102b is of a generally U shape or a flat asymmetrical horseshoe shape.

In an embodiment, the cage member 105 is generally U shaped as exemplarily illustrated in FIG. 3. The cage member 105 comprises a receptacle 106 of, for example, a generally U shape for accommodating the device 201. In an embodiment, the cage member 105 comprises at least two openings 120a and 120b configured to be pivotally connected to the arms 102a and 102b of the frame member 102 via the hinge elements 104a and 104b respectively, using at least two tension fasteners 121a and 121b, for example, M5×10 stainless steel button head cap screws or a quick release fastener fastened into the openings 120a and 120b. The tension fasteners 121a and 121b are inserted through the openings 120a and 120b of

7

the cage member **105** and through the openings **122a** and **122b** of the hinge elements **104a** and **104b** respectively, to pivotally connect the cage member **105** to the frame member **102**. The cage member **105** pivotally rotates about the pivotal axis X-X exemplarily illustrated in FIGS. 1A-1B. The pivotal axis X-X passes through the openings **120a** and **120b** of the cage member **105**.

The two tension fasteners **121a** and **121b** are tightened to hold the cage member **105** in one of the positions, for example, the upright position or the inverted position under a tension at the arms **102a** and **102b** of the frame member **102**. The two tension fasteners **121a** and **121b** are loosened to release the tension from the cage member **105** and allow the pivotal rotation of the cage member **105** about the pivotal axis X-X and repositioning of the cage member **105** with respect to the frame member **102**, and then are re-tightened to hold the cage member **105** in the new position. Consider an example where the cage member **105** and the frame member **102** are held together by two tension fasteners **121a** and **121b**, for example, button head cap screws. These button head cap screws create the tension that holds the cage member **105** in the upright position and the inverted position. In order to rotate the cage member **105**, the button head cap screws are loosened, the cage member **105** is rotated, and then the button head cap screws are re-tightened. In an embodiment, a single tension fastener, tensioner or detent, for example, **121a** or **121b**, is used to secure the cage member **105** to the frame member **102** in position. In another embodiment, a double tension fastener, tensioner or detent (not shown) is used to secure the cage member **105** to the frame member **102** in position. For purposes of illustration, the detailed description refers to tension fasteners being button head cap screws, for example, **121a** and **121b**, and single or double tension fasteners used to create the tension to lock the cage member **105** in the upright position and the inverted position; however the scope of the flippable device support and trigger apparatus **100a** disclosed herein is not limited to the tension fasteners being button head cap screws, for example, **121a** and **121b**, and single or double tension fasteners, but may be extended to include other types of fasteners, quick release mechanisms, and functionally equivalent structures that can be used for creating the tension to lock the cage member **105** in the upright position and the inverted position.

In an embodiment, the receptacle **106** of the cage member **105** is configured in one of multiple shapes and sizes to accommodate any device **201** of any shape and size. The cage member **105** can be configured or shaped to mount other devices of multiple shapes and sizes, for example, other brands of still image cameras, video cameras, mobile phones with in-built cameras, smart phones, music players, etc. The device **201**, for example, a GoPro® camera is fastened to the receptacle **106** of the cage member **105** using a device fastener **301**, for example, a screw fastener commercially supplied along with a GoPro® camera. The triggering assembly **107** comprises the trigger section **109** and the actuation section **110**. The trigger section **109** is pivotally connected to the actuation section **110**. An O-ring member **123**, for example, a spring return element, is coupled with a fastener screw **124** and a washer **125** to pivotally connect the trigger section **109** and the actuation section **110** at the notch **111** positioned on the support section **103** of the frame member **102**. The fastener screw **124** is, for example, a #4-40×½" inch stainless steel button head cap screw. The washer **125** is, for example, a #4 stainless steel washer.

As exemplarily illustrated in FIG. 3, the push rod assembly **108** comprises a rod member **112** and a push button **113**. The rod member **112** is, for example, an elongate rod. The push

8

button **113** is, for example, a thumb button configured to be pushed by a thumb of a user. The rod member **112** is inserted through an opening **126** in the handle **101** to operably communicate with the trigger section **109** of the triggering assembly **107** as disclosed in the detailed description of FIG. 2A-2B.

FIGS. 4A-4I exemplarily illustrate different elevation views of the flippable device support and trigger apparatus **100a**. FIG. 4A exemplarily illustrates a front elevation view of the flippable device support and trigger apparatus **100a**, showing the cage member **105** positioned in an upright position in front of the handle **101**. FIG. 4B exemplarily illustrates a top plan view of the flippable device support and trigger apparatus **100a** when the cage member **105** is positioned in an upright position. FIG. 4C exemplarily illustrates a bottom view of the flippable device support and trigger apparatus **100a** when the cage member **105** is positioned in the upright position. FIG. 4D exemplarily illustrates a right side elevation view of the flippable device support and trigger apparatus **100a**, showing the cage member **105** positioned in the upright position in front of the handle **101**. FIG. 4E exemplarily illustrates a left side elevation view of the flippable device support and trigger apparatus **100a**, showing the cage member **105** positioned in the upright position in front of the handle **101**. FIG. 4F exemplarily illustrates a front elevation view of the flippable device support and trigger apparatus **100a**, showing the cage member **105** positioned in an inverted position above the handle **101**. FIG. 4G exemplarily illustrates a top plan view of the flippable device support and trigger apparatus **100a** when the cage member **105** is positioned in the inverted position. FIG. 4H exemplarily illustrates a bottom view of the flippable device support and trigger apparatus **100a** when the cage member **105** is positioned in the inverted position. FIG. 4I exemplarily illustrates a right side elevation view of the flippable device support and trigger apparatus **100a**, showing the cage member **105** positioned in the inverted position above the handle **101**.

The flippable device support and trigger apparatus **100a** is assembled by interconnecting different components, for example, the handle **101**, the frame member **102**, the cage member **105**, the triggering assembly **107**, and the push rod assembly **108**. The frame member **102** is fastened to the intermediate member **117** that extends from the handle **101** by inserting the fastening members **119** exemplarily illustrated in FIG. 3, for example, four flat Allen screws, into the through holes **103c** of the frame member **102** exemplarily illustrated in FIG. 3, and then into the through holes **118** of the intermediate member **117** while maintaining the triggering assembly **107** in position at the notch **111**. The triggering assembly **107** is seated and pivotally connected on the notch **111** positioned on the support section **103** of the frame member **102**.

The openings **120a** and **120b** of the cage member **105** are aligned with the openings **122a** and **122b** of the hinge elements **104a** and **104b** that are connected to the arms **102a** and **102b** of the frame member **102** respectively as exemplarily illustrated in FIG. 3. The tension fasteners **121a** and **121b** exemplarily illustrated in FIG. 3, are inserted through the openings **120a** and **120b** of the cage member **105** and through the openings **122a** and **122b** of the hinge elements **104a** and **104b** respectively, to pivotally fasten the cage member **105** to the frame member **102**. The push rod assembly **108** exemplarily illustrated in FIG. 3, is connected to the handle **101** by inserting the rod member **112** with the push button **113** through the opening **126** in the handle **101** to communicate with the trigger section **109** of the triggering assembly **107**. The device **201** is further fastened in the receptacle **106** of the cage member **105** using the device fastener **301**. In an

embodiment, each component of the flippable device support and trigger apparatus **100a** is manufactured, for example, by computer numerical control (CNC) machining from billet or extrusion, cast from metals, or can be injection molded from plastics. The dimensions of the flippable device support and trigger apparatus **100a** in the upright position is, for example, about 6.5 inches×5.5 inches×3 inches. The dimensions of the flippable device support and trigger apparatus **100a** in the flipped or inverted position is, for example, about 8 inches×7 inches×3 inches.

FIGS. 5A-5B exemplarily illustrate left side perspective views of the flippable device support and trigger apparatus **100a**, showing actuation of the triggering assembly **107** of the flippable device support and trigger apparatus **100a** for actuating an activation button **202** of a device **201** positioned in the receptacle **106** of the cage member **105** in an upright position in front of the handle **101**. A user tightens the two tension fasteners **121a** and **121b** to position the cage member **105** in the upright position under tension at the arms **102a** and **102b** of the frame member **102**. The device **201**, for example, a GoPro® camera, is powered on and accommodated in the receptacle **106** of the cage member **105** and fastened therein using the device fastener **301** exemplarily illustrated in FIG. 3, such that a tip **110a** of the actuation section **110** of the triggering assembly **107** is proximal to the activation button **202** of the device **201**. As exemplarily illustrated in FIG. 5A, the trigger section **109** of the triggering assembly **107** is pulled in a backward direction as exemplarily illustrated by the direction of the block arrow shown proximal to the trigger section **109** in FIG. 5A, for example, using the index finger of one hand of the user, to provide leverage for the actuation section **110** pivotally connected to the trigger section **109** to move in a downward direction as exemplarily illustrated by the direction of the block arrow shown proximal to the actuation section **110** in FIG. 5A. The movement of the actuation section **110** in the downward direction allows the tip **110a** of the actuation section **110** to make contact with the activation button **202** of the device **201** as exemplarily illustrated in FIG. 5B. The change in position of the triggering assembly **107** prior to and after the pull of the trigger section **109** of the triggering assembly **107** by the user's index finger is exemplarily illustrated in FIG. 5B. The activation button **202** of the device **201** is therefore pressed in a downward direction by the tip **110a** of the actuation section **110** to trigger the device **201** to capture a still image and/or a moving image or video of an object or an environment in front of the user.

FIGS. 6A-6B exemplarily illustrate left side elevation views of the flippable device support and trigger apparatus **100a**, showing actuation of the triggering assembly **107** for actuating an activation button **202** of a device **201** positioned in the receptacle **106** of the cage member **105** in an inverted position above the handle **101**. In an example, when a user wants to capture self portrait still images and/or moving images or videos of one's self in an environment using the device **201**, for example, a GoPro® camera, the user loosens the two tension fasteners **121a** and **121b** to release the tension from the cage member **105** to allow the cage member **105** to be pivotally rotated and repositioned with respect to the frame member **102** in a flipped or inverted position. As exemplarily illustrated by the block arrow shown proximal to the push button **113** of the push rod assembly **108** in FIG. 6A, the user pushes the push button **113** of the push rod assembly **108**, for example, using the thumb of one hand, to allow the end **112b** of the rod member **112** of the push rod assembly **108** to move in a forward direction as exemplarily illustrated by the block arrow shown proximal to the trigger section **109** of the triggering assembly **107** in FIG. 6A, to contact the trigger section

109 as exemplarily illustrated in FIG. 6B. As exemplarily illustrated by the block arrows in FIG. 6B, the trigger section **109** actuates the actuation section **110** of the triggering assembly **107** to press the activation button **202** of the device **201**. The actuation section **110** pivotally connected to the trigger section **109** moves in a generally upward direction as exemplarily illustrated by the direction of the block arrow shown proximal to the actuation section **110** in FIG. 6A. The change in position of the triggering assembly **107** prior to and after the push of the push button **113** of the push rod assembly **108** by the user's thumb is exemplarily illustrated in FIG. 6B. Since the user is standing behind the flippable device support and trigger apparatus **100a**, the device **201**, for example, the camera mounted in the flipped or inverted cage member **105** faces the user to allow the user to capture a self portrait still image and/or moving image or video. The triggering assembly **107** of the flippable device support and trigger apparatus **100a** provides a single pivot point trigger or shutter activation mechanism for the lens of the camera.

As exemplarily illustrated in FIGS. 5A-5B and FIGS. 6A-6B, the structure of the flippable device support and trigger apparatus **100a** enables placement of the device **201** in front of the hand that holds the handle **101**; provides the triggering assembly **107** that acts as a single pivot point trigger or button activation mechanism that can be activated from either one or two positions by one hand; and a hinged or pivotal connection of the cage member **105** to the frame member **102** that allows the device **201**, for example, a camera to pivot and be activated in one or two positions, for example, the upright position and/or the inverted position by one hand. In an embodiment, the flippable device support and trigger apparatus **100a** allows positioning of the cage member **105** at any angle with respect to the frame member **102** in one of multiple positions to enable the user to capture still images and/or moving images of one or more objects or an environment from any angle.

FIGS. 7A-7B exemplarily illustrate perspective views of an embodiment showing a non-flippable device support and trigger apparatus **100b**. In this embodiment, the non-flippable device support and trigger apparatus **100b** comprises the handle **101**, frame member **102**, the cage member **105**, and the triggering assembly **107**. The cage member **105** of the non-flippable device support and trigger apparatus **100b** is rigidly connected to the arms **102a** and **102b** of the frame member **102** in an upright position in front of the handle **101**, using tension fasteners **127a** and **127b**. The tension fasteners **127a** and **127b** are tightened to hold the cage member **105** in the upright position under a tension at the arms **102a** and **102b** of the frame member **102**. The cage member **105** accommodates a device **201** in the upright position as exemplarily illustrated in FIG. 7B, to allow a user to capture still images and/or moving images or videos of objects or an environment in front of the user.

As exemplarily illustrated in FIG. 7B, the device **201**, for example, the GoPro® camera is mounted into the receptacle **106** of the cage member **105** exemplarily illustrated in FIG. 7A, and secured in position by inserting and tightening the device fastener **301** or the knob into a bottom threaded portion **105d** of the cage member **105**. The handle **101** is held in one hand of the user and the triggering assembly **107** is pulled using an index finger of the same hand. The operation of the triggering assembly **107** comprising the trigger section **109** and the actuation section **110** to actuate the activation button **202** of the device **201** in the upright position is disclosed in the detailed description of FIGS. 5A-5B. The triggering assembly **107** pivotally moves within the notch **111** of the frame member **102** to contact and depress the activation button **202**

11

of the device **201** to click still images and/or moving images or videos of objects or an environment in front of the user.

FIG. **8** illustrates a method for triggering a device **201** exemplarily illustrated in FIG. **7B**, in an upright position using one hand. A non-flippable device support and trigger apparatus **100b** comprising the handle **101**, the frame member **102**, the cage member **105**, and the triggering assembly **107** as exemplarily illustrated in FIGS. **7A-7B**, is provided **801**. The device **201** is positioned **802** in the receptacle **106** of the cage member **105** in an upright position in front of the handle **101**. A user using one hand pulls **803** the trigger section **109** of the triggering assembly **107** to bring the actuation section **110** of the triggering assembly **107** in contact with the activation button **202** of the device **201** positioned in the receptacle **106** of the cage member **105** in the upright position in front of the handle **101**. The actuation section **110** actuates **804** the activation button **202** of the device **201** to trigger the device **201** to capture still images and/or moving images or videos of objects or an environment in front of the user.

FIG. **9** illustrates a method for triggering a device **201** exemplarily illustrated in FIGS. **2A-2B**, in an upright position and an inverted position using one hand. A flippable device support and trigger apparatus **100a** comprising the handle **101**, the frame member **102**, the cage member **105**, the triggering assembly **107**, and the push rod assembly **108** as exemplarily illustrated in FIGS. **1A-6B**, is provided **901**. The device **201** is accommodated **902** in the receptacle **106** of the cage member **105**. The cage member **105** with the accommodated device **201** is positioned **903** in an upright position in front of the handle **101** to position the accommodated device **201** in the upright position in front of the handle **101**. A user using one hand pulls **904** the trigger section **109** of the triggering assembly **107** to bring the actuation section **110** of the triggering assembly **107** in contact with the activation button **202** of the accommodated device **201** in the upright position in front of the handle **101**. The actuation section **110** actuates **905** the activation button **202** of the accommodated device **201** in the upright position in front of the handle **101** to trigger the accommodated device **201** in the upright position in front of the handle **101** to capture still images and/or moving images or videos of objects or an environment in front of the user. The cage member **105** is pivotally rotated **906** to the inverted position above the handle **101** to position the accommodated device **201** in the inverted position above the handle **101**. The user presses the push button **113** of the push rod assembly **108** using one hand to push **907** the trigger section **109** of the triggering assembly **107** to bring the actuation section **110** of the triggering assembly **107** in contact with the activation button **202** of the accommodated device **201** in the inverted position above the handle **101**. The actuation section **110** actuates **908** the activation button **202** of the accommodated device **201** in the inverted position above the handle **101** to trigger the accommodated device **201** in the inverted position above the handle **101** to capture still images and/or moving images or videos of one's self in an environment.

The foregoing examples have been provided merely for the purpose of explanation and are in no way to be construed as limiting of the present invention disclosed herein. While the invention has been described with reference to various embodiments, it is understood that the words, which have been used herein, are words of description and illustration, rather than words of limitation. Further, although the invention has been described herein with reference to particular means, materials, and embodiments, the invention is not intended to be limited to the particulars disclosed herein; rather, the invention extends to all functionally equivalent structures, methods and uses, such as are within the scope of

12

the appended claims. Those skilled in the art, having the benefit of the teachings of this specification, may effect numerous modifications thereto and changes may be made without departing from the scope and spirit of the invention in its aspects.

We claim:

1. A device support and trigger apparatus comprising:

a handle;

a frame member fixedly attached to an upper end of said handle, said frame member comprising a support section and arms, said arms extending from opposing ends of said support section;

a cage member pivotally connected to said arms of said frame member, said cage member comprising a receptacle configured to accommodate a device, said cage member configured to be positioned at a predefined angle with respect to said frame member and pivotally rotated to one of a plurality of positions to position said device in said one of said positions, said positions comprising an upright position in front of said handle and an inverted position above said handle;

a triggering assembly configured to operably communicate with said device accommodated in said receptacle of said cage member, said triggering assembly comprising a trigger section and an actuation section, said trigger section pivotally connected to said actuation section at a notch positioned on said support section of said frame member, said actuation section extending above said receptacle of said cage member and configured to contact an activation button of said device, and said trigger section configured to be pulled using one hand to bring said actuation section in contact with said activation button of said device to actuate said activation button of said device when said cage member with said accommodated device is positioned in said upright position in front of said handle; and

a push rod assembly comprising:

a rod member inserted through an opening in said handle to contact said trigger section of said triggering assembly; and

a push button operably connected to a distal end of said rod member, said push button configured to push said trigger section of said triggering assembly via said rod member when pressed using said one hand to bring said actuation section of said triggering assembly in contact with said activation button of said device to actuate said activation button of said device when said cage member with said accommodated device is positioned in said inverted position above said handle.

2. The device support and trigger apparatus of claim 1, wherein said handle comprises a handle frame, a first segment, and a second segment, wherein said first segment and said second segment are adjoined to each other within a space defined in said handle frame.

3. The device support and trigger apparatus of claim 1, further comprising an intermediate member fixedly attached to and extending from said handle, wherein said intermediate member comprises one or more through holes to fixedly attach to said frame member using one or more fastening members.

4. The device support and trigger apparatus of claim 1, wherein said frame member is of a generally U shape.

5. The device support and trigger apparatus of claim 1, wherein said cage member is of a generally U shape.

6. The device support and trigger apparatus of claim 1, wherein said cage member comprises at least two openings configured to be pivotally connected to said arms of said

13

frame member using at least two tension fasteners, wherein said at least two tension fasteners are tightened to hold said cage member in said one of said positions under a tension at said arms of said frame member, and wherein said at least two tension fasteners are loosened to release said tension from said cage member and allow said pivotal rotation and repositioning of said cage member with respect to said frame member.

7. The device support and trigger apparatus of claim 1, wherein said receptacle of said cage member is configured in one of a plurality of shapes and sizes to accommodate said device of one of different shapes and sizes.

8. A method for positioning and triggering a device in one of a plurality of positions using one hand, said method comprising:

providing a device support and trigger apparatus comprising:

a handle, said handle configured to be held in said one hand;

a frame member fixedly attached to an upper end of said handle, said frame member comprising a support section and arms, said arms extending from opposing ends of said support section;

a cage member pivotally connected to said arms of said frame member, said cage member comprising a receptacle configured to accommodate said device, said cage member configured to be positioned at a predefined angle with respect to said frame member and pivotally rotated to one of a plurality of positions to position said device in said one of said positions, said positions comprising an upright position in front of said handle and an inverted position above said handle;

a triggering assembly configured to operably communicate with said device accommodated in said receptacle of said cage member, said triggering assembly comprising a trigger section and an actuation section, said trigger section pivotally connected to said actuation section at a notch positioned on said support section of said frame member, said actuation section extending above said receptacle of said cage member and configured to contact an activation button of said device; and

a push rod assembly comprising:

a rod member inserted through an opening in said handle to contact said trigger section of said triggering assembly; and

a push button operably connected to a distal end of said rod member;

14

accommodating said device in said receptacle of said cage member of said device support and trigger apparatus;

positioning said cage member with said accommodated device in said upright position in front of said handle to position said accommodated device in said upright position in front of said handle;

pulling said trigger section of said triggering assembly of said device support and trigger apparatus using said one hand to bring said actuation section of said triggering assembly in contact with said activation button of said accommodated device in said upright position in front of said handle;

actuating said activation button of said accommodated device in said upright position in front of said handle by said actuation section of said triggering assembly to trigger said accommodated device in said upright position in front of said handle;

pivotally rotating said cage member to said inverted position above said handle to position said accommodated device in said inverted position above said handle;

pushing said trigger section of said triggering assembly by pressing said push button of said push rod assembly of said device support and trigger apparatus using said one hand to bring said actuation section of said triggering assembly in contact with said activation button of said accommodated device in said inverted position above said handle; and

actuating said activation button of said accommodated device in said inverted position above said handle by said actuation section of said triggering assembly to trigger said accommodated device in said inverted position above said handle.

9. The method of claim 8, wherein said frame member of said device support and trigger apparatus is of a generally U shape, and wherein said cage member of said device support and trigger apparatus is of a generally U shape.

10. The method of claim 8, wherein said cage member of said device support and trigger apparatus further comprises at least two openings configured to be pivotally connected to said arms of said frame member using at least two tension fasteners, wherein said at least two tension fasteners are tightened to hold said cage member in said one of said positions under a tension at said arms of said frame member, and wherein said at least two tension fasteners are loosened to release said tension from said cage member and allow said pivotal rotation and repositioning of said cage member with respect to said frame member.

* * * * *